

# Quick Start Guide - QX and SX Recorders

## 1. Connections

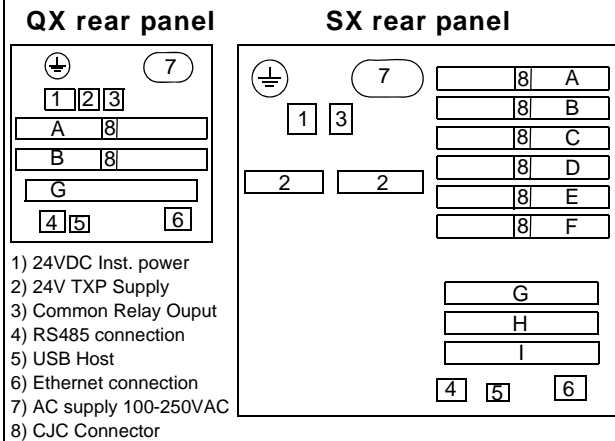

### Analogue Input board (4, 6 or 8 channel).

QX = Slots A & B, SX = Slots A to F

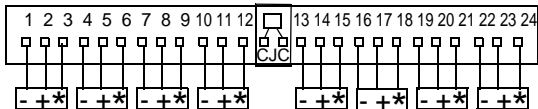

mV, V    T/C Passive    T/C Active    Current

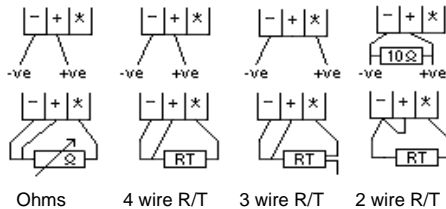

Analogue Output (2 or 4 channel). QX = Slot B only, SX = Slots E&F

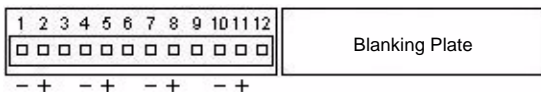

Pulse Input (4 channel). QX = Slots A & B, SX = Slots A to F

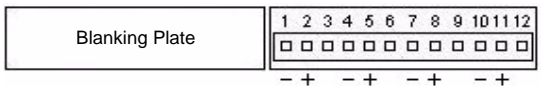

Relay Alarm (4 or 8 channel). QX = Slot G, SX = Slots G to I

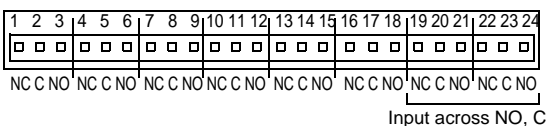

Digital Input/Output (8 or 16 channel). QX = Slot G, SX = Slots G to I

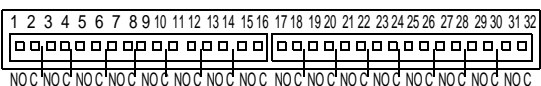

Key: NO = Normally Open, C = Common, NC = Normally Closed,

(2) 24V Transmitter Power Supply connections are made via 2-way for QX, 2x10-way connectors for SX.

## 2. Setup Menu



Select the Menu button from the Process Screen



### Options

Select Options in Credits menu, tick firmware options to enable. Go to Finish and Commit



### Inputs

All Analogue Inputs default to 12V



Select Input channel

- Setup input Type. V, A, Ohms, RT, TC
- Select Sample Rate
- Select Range / RT / TC Type

Use Back button to return to Setup Menu

### Pens

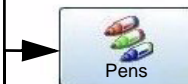

By default Pen 1 displays Analogue Input 1, Pen 2 displays Analogue 2 etc.

Select Pen

- Setup Scale
- Set Alarms, if required
- Setup Logging (required to Log and Save data in memory)

Use Back button to return to Setup Menu

### Localization

Settings for Language and Time Zones, etc.



### Settings (Main Menu > Configure)



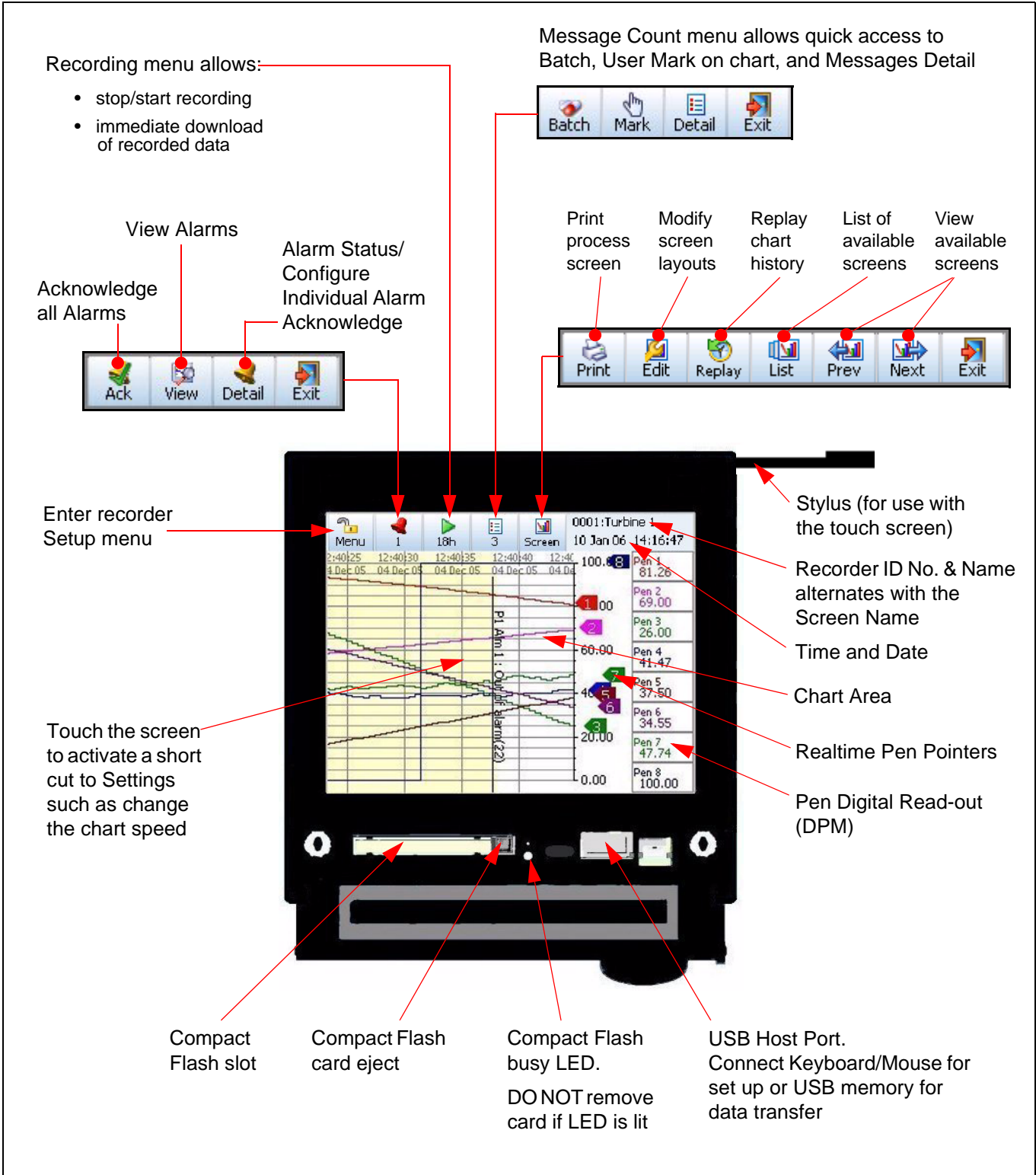

**NOTICE**

For detailed information on all recorder settings and configuration parameters please refer to the QX and SX User manual.