Instruction manual series 854 ATG level gauge

July 2008
Part no. 4416.220
Rev. 5



Enraf B.V.
P.O. Box 812
2600 AV Delft
Netherlands

Honeywell Enraf

Tel. : +31 15 2701 100
Fax : +31 15 2701 111
E-mail : enraf-nl@honeywell.com
Website : <http://www.honeywellenraf.com>

Copyright 1999 - 2008 Enraf B.V. All rights reserved.

Reproduction in any form without the prior consent of Enraf B.V. is not allowed. This manual is for information only. The contents, descriptions and specifications are subject to change without notice. Enraf B.V. accepts no responsibility for any errors that may appear in this manual.

The warranty terms and conditions applicable in the country of purchase in respect to Enraf B.V. products are available from your supplier. Please retain them with your proof of purchase.

Preface

This manual is intended for technicians involved with the commissioning and service of the Honeywell Enraf series 854 Advanced Technology Gauge.

A description preceding the technical procedures gives the technical information necessary to understand its functioning. It is recommended to read this description prior to performing any of the procedures.

For mechanical and electrical installation of the 854 ATG, refer to the Installation guide 854 Advanced Technology Gauge. This manual describes the commissioning, maintenance and trouble shooting of the basic 854 ATG level measurement. Other features such as: level alarm outputs, analog level output, temperature measurement, pressure measurement, etc. are describes in separate manuals. For an overview, refer to the list of related documents in Appendix F.

Legal aspects

The information in this manual is copyright property of Enraf B.V., Netherlands.
Enraf B.V. disclaims any responsibility for personal injury or damage to equipment caused by:

- Deviation from any of the prescribed procedures;
- Execution of activities that are not prescribed;
- Negligence of the general safety precautions for handling tools, use of electricity and microwave radiation.

EC declaration of conformity

This instrument is in conformity with the protection requirements of EC Council Directive 89/336/EEC.
The CE conformity marking fulfills the provisions of

EN 50081-2 Generic Emission Standard
EN 50082-2 Generic Immunity Standard
73/23EEC Low Voltage Directive

when installed, maintained and applied according to requirements as specified in this manual.

Additional information

Please do not hesitate to contact Honeywell Enraf or its representative if you require additional information.

Table of contents

Preface	3
1 Introduction	6
1.1 Principle of measurement	6
1.1.1 Level measurement	7
1.1.2 Interface between two products	7
1.1.3 Relative density	7
1.2 Optional functions	7
1.3 Remote monitoring	8
1.4 Approvals (FM, CENELEC)	8
2 Safety	9
2.1 Safety aspects of the 854 Advanced Technology Gauge	9
2.2 Personal safety	10
2.3 Safety conventions	10
3 Commissioning	11
3.1 Checks before starting the commissioning	11
3.2 Installation of measuring drum and displacer	12
3.2.1 Tools	12
3.2.2 Installation of measuring drum	12
3.2.3 Installation of displacer	13
3.2.4 Unlocking (locking) the motor block	13
3.3 Programming (configuring) the gauge	14
3.3.1 Introduction into programming	14
3.3.2 Apply power to the 854 ATG	16
3.3.3 Selecting dimension and decimal separator	17
3.3.4 Tank and gauge data	18
3.3.5 Alarm settings	20
3.3.6 Ullage readout	21
3.3.7 Display control and password protection	22
3.4 Level calibration	23
3.4.1 Standard level calibration	23
3.4.2 Level calibration with a tank top reference stop	23
3.4.3 Level calibration using the top of ball valve	24
3.4.4 Interface measurement	25
4 Operation	26
4.1 Display	26
4.1.1 XPU display	27
4.1.2 XPU-2 display	27
4.2 Repeatability test	29
4.3 Lock test	29
4.4 Freeze and block commands	30
4.5 Unlock	30
4.6 Interface measurement	31
4.7 Dip mode	31
4.8 Verify level calibration	32
4.8.1 Verify level calibration against a tank top reference stop	32
4.8.2 Verify level calibration on top of ball valve	32
4.9 Data items and operational commands	33

5	Maintenance	34
5.1	Preventive maintenance	34
5.2	Instrument covers	35
5.3	Drum compartment	36
5.3.1	Detailed description	36
5.3.2	Removing the measuring drum	37
5.3.3	Replacing the drum bearings	38
5.4	The electronic compartment	39
5.4.1	Detailed description	39
5.4.2	Dismantling the electronic compartment	40
5.4.3	Replacing software	41
5.4.4	Initializing NOVRAM	41
5.5	Calibrating force transducer	42
5.6	Synchronizing the reference encoder	43
6	Trouble shooting	44
6.1	Problems with displacer movement	44
6.2	XPU error code (item EP)	45
6.3	SPU error code (item ES)	45
6.4	SPU status request (item QS)	46
	Appendix A Article and part numbers	47
	Appendix B Additional information on displacers	50
	Appendix C ASCII table	52
	Appendix D Display formats	53
	Appendix E PCB layout	58
	Appendix F Related documents	59
	Index	60

1 Introduction

The Honeywell Enraf 854 ATG (Advanced Technology Gauge) measures the liquid level and can be programmed to measure two additional interface levels.

The 854 ATG has four programmable level alarms, and also provides diagnostic information. This information can be displayed on the internal display, the Portable Enraf Terminal (PET) as well as on remote systems.

Optionally, the instrument can be provided with software for density measurement of the stored product.

The 854 ATG can be supplied with an optional board (called: HCU board) to interface optional equipment as:

- Spot temperature element (Pt100 RTD)
- Average temperature element (VITO temperature probe, VITO LT temperature probe, MRT element)
- Water bottom probe (VITO water probe, combined VITO temperature/water probe, external HART water probe)
- Pressure transmitters (for vapour pressure measurement, HIMS density measurement)
- Analog 4-20 mA level output

The above functions are separately available or in combinations as with the previous MPU, HPU, HSU and TPU optional boards. Refer to the below table:

Sales code option board (4 th position)	Available functions HCU board	Emulation mode
B	Spot temperature Pt100 RTD	TPU-2/ HSU
C	VITO temperature and/or water probe	HPU
J	VITO temperature and/or water probe + HART device(s)	HPU
U	Spot temperature Pt100 RTD + HART device(s)	HSU
V	Analog level output	MPU
W	Analog level output + VITO temperature and/or water probe	HCU
X	Analog level output + VITO temperature probe	MPU
Y	Analog level output + Spot temperature Pt100 RTD + VITO temperature and/or water probe + HART device(s)	HCU

Notes:

- 1 HART device(s) can be:
 - HART pressure transmitters for vapour pressure measurement or HIMS density measurement
 - HART water bottom probes.
- 2 With sales code Y (all HCU functions), the spot temperature measurement is disabled if a VITO temperature probe is present.

1.1 Principle of measurement

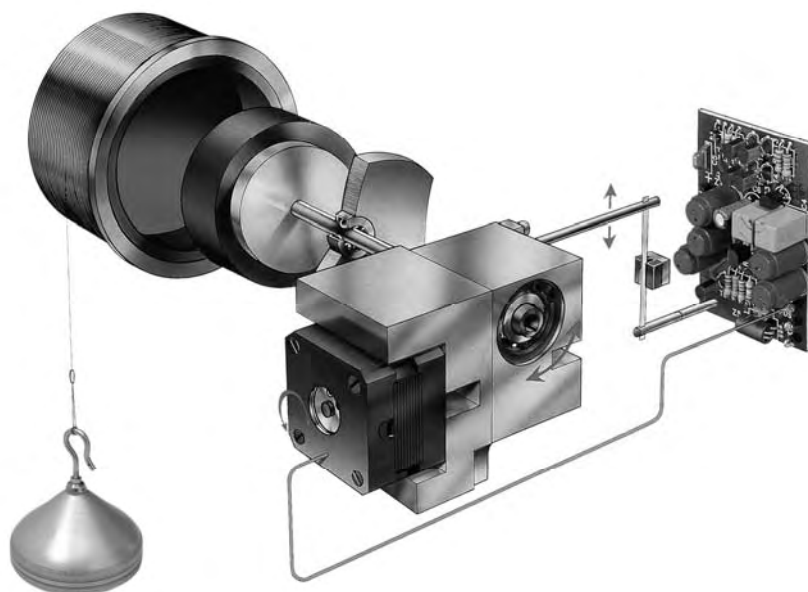

Figure 1.1 Principle of measurement

The principle is based on detection of variations in the buoyancy of a displacer. The displacer is suspended from a strong, flexible measuring wire which is stored on a precisely grooved measuring drum. The shaft of the drum is connected to the stepper motor via a magnetic coupling.

The apparent weight of the displacer is measured by a force transducer. The actual output of the force transducer is compared with a desired value for the apparent weight of the displacer. If a discrepancy exists between measured and desired value, an advanced software control module adjusts the position of the stepper motor.

1.1.1 Level measurement

A level variation of product, in which the displacer is partially immersed, causes a change in buoyancy, which will be detected by the force transducer. The resulting difference between measured and desired value will cause a variation in the position of the stepper motor and consequently raise or lower the position of the displacer until the measured value equals the desired value.

To avoid oscillations, a certain hysteresis and integration time is software adjustable. This results in a stable and accurate averaged level measurement.

The stepper motor turns one revolution for every 10 mm of vertical movement of the displacer. One revolution is divided into 200 steps, therefore one step is equivalent to 0.05 mm. This resolution is direct consequence of the stepper motor principle. The correct functioning of the stepper motor is continuously checked. This is achieved by decoding the unique pattern of an encoder disk mounted on the motor shaft.

1.1.2 Interface between two products

Measurement of the interface between two products is achieved by sending an interface command to the gauge. This causes the stepper motor processor to move the displacer to a position where the apparent weight of the displacer matches a pre-programmed set point.

1.1.3 Relative density

To measure the relative density, the displacer is positioned at specific heights and the apparent weight of the displacer at each height is measured. Knowing the volume of the displacer, its weight in air, and the measured apparent weight, the relative density of the product at each position of the displacer can be calculated. The software for the density measurement is available as an option.

1.2 Optional functions

Optional functions as temperature measurement, pressure measurement, water bottom measurement, HIMS density measurement and analog level output requires the optional HCU board to be installed.

Alarm relays are optionally available on the SPU II board. Density measurement is an optional module of the SPU software.

The table below gives an overview of all options and related manuals.

Option	Board	Refer to
Level alarm output relays (or digital outputs)	SPU II	Instruction manual SPU II Hard alarm output contacts
Density measurement	SPU II	Instruction manual 854 density option
Analog level output (4-20 mA)	HCU	Instruction manual Temperature, Water bottom and Analog output options
Spot temperature measurement	HCU	Instruction manual VITO
Average temperature measurement via VITO temperature probe or MRT	HCU	Instruction manual VITO
Pressure measurement for mass, density and/or vapour pressure measurement	HCU	Instruction manual HIMS
Water bottom measurement	HCU	Instruction manual Temperature, Water bottom and Analog output options
Connection for 977 TSI Tank Side Indicator	XPU-2	Instruction manual 977 TSI Tank Side Indicator
RS-232C / RS-485 communication	XPU-2	Instruction manual XPU-2 option RS-232C / RS-485
Foundation Field Bus	GFC	Instruction manual Foundation™ Fieldbus interface

1.3 Remote monitoring

Central monitoring of the 854 ATG is possible via tank inventory systems such as Entis Pro and Entis XS. Remote display can be achieved by using the 877 FDI field indicator, the 977 TSI tank side indicator or the 878 CPI panel indicator.

1.4 Approvals (ATEX, FM)

The Honeywell Enraf 854 Advanced Technology Gauges are certified by official testing institutes as KEMA (ATEX) and Factory Mutual to be explosion proof (suitable for zone 0). The gauges are also approved and certified by Weights and Measures (W&M) or Custom and Excise authorities for legal use and custody transfer.

2 Safety

Warning

*The 854 ATG is designed to measure the liquid level in storage tanks. The instrument is suitable for flammable liquids (refer to the explosion proof certification data below).
For other applications contact Honeywell Enraf.*

2.1 Safety aspects of the 854 Advanced Technology Gauge

Warning

Do not use the instrument for anything else than its intended purpose.

For medium pressure versions (till 6 bar), the 854 ATG drum compartment housing is of aluminum, and for chemical version it is of stainless steel.

For high pressure version (max. 25 bar), the 854 ATG housing is of stainless steel.

The housing of the 854 ATG is explosion-proof:

- II 1/2 G EEx de [ib/ia] IIB T6 acc. to KEMA 01ATEX2092 X, certified by KEMA, Netherlands
- Class I, Division 1, Groups B, C & , acc. to ANSI/NFPA no. 70, certified by Factory Mutual Research USA (FM no.: 3Q2A9.AX)
- Ex d IIB T6, IP54, Class I, Zone 1 according to SAA

Environmental conditions for the 854 ATG are:

ambient temperature	: -40 to + 65 °C (-40 to +149 °F)
operating pressure	: max. 6 bar for medium pressure and chemical version max. 25 bar for high pressure version
relative humidity	: 0 - 100 %
ingress protection	: IP65 (NEMA 4), suitable for outdoor installation

The drum compartment, which is in contact with the tank atmosphere, is separated from electronic compartment. A magnetic coupling transfers the drum movement (hence, displacer movement) to electronic compartment.

Wiring for intrinsically safe options, such as temperature or pressure measurement, is fed via two separate cable entries.

The 854 ATG covers can optionally be provided with sealing facilities on blocking devices, which prevents unauthorized opening.

Warning

*Improper installation of cable glands, conduits or stopping plugs
Will invalidate the Ex approval of the 854 ATG.*

2.2 Personal safety

Safe execution of the procedures in this manual requires technical experience in handling tools, and knowledge of safety regulations in handling electrical installation in hazardous environments.

The sequence of steps in a procedure may also be important from the point of view of personal safety and prevention of damage; it is therefore advised not to change the sequence of procedure steps or modify any procedure in any other way.

Warning

*In hazardous areas it is compulsory to use personal protection and safety gear such as:
hard hat, fire resistive overall, safety shoes, safety glasses and working gloves.*

*Avoid possible generation of static electricity. Use non-sparking tools and explosion proof testers.
Do not open any of the instrument covers while power is still connected.*

Never start working before the work permit is signed by all parties.

*Pay attention to the kind of product in the tank. If any danger for health, wear a gas mask
and take all necessary precautions.*

2.3 Safety conventions

"Warnings", "Cautions", and "Notes" have been used throughout this manual to bring special matters to the immediate attention of the reader.

- A **Warning** concerns danger to the safety of the technician or user;
- A **Caution** draws attention to an action which may damage the equipment;
- A **Note** points out a statement deserving more emphasis than the general text, but does not deserve a "Warning" or a "Caution".

3 Commissioning

Caution

*Keep screw thread from the compartment covers free from dirt.
Grease them lightly with an acid-free grease before closing the instrument.
When closing, turn the covers counter-clockwise until the thread clicks into place, then turn clockwise.*

3.1 Checks before starting the commissioning

Examine the mechanical and electrical installation after the 854 ATG is installed on the tank. Refer to the installation guide 854 Advanced Technology Gauge.

- Check the correct orientation of the gauge with respect to the tank.
- Check that the gauge is leveled within 2°.
- Check that the O-ring and gaskets are supplied.
- Check that the mains voltage selector of the 854 ATG indicates the local mains supply.
- Check the connections of all electrical cabling.
- Check the ground connection of the 854 ATG to the tank.
- Check that non-used cable inlets are sealed with appropriate stopping plugs.
- Close carefully all covers (mind the O-rings) before any electrical power is applied.

3.2 Installation of measuring drum and displacer

3.2.1 Tools

It is recommended to use an 847 PET (Portable Enraf Terminal) to load the different parameters. A tool set for commissioning and maintenance is available from Honeywell Enraf (see figure 3.1).

Item	Description
1	Allen key 2 mm
2	Allen key 3 mm
3	Allen key 4 mm
4	Allen key 5 mm
5	Allen key 8 mm
6	Drum bearing puller
7	test magnet
8	Screwdriver for Allen key screws M4
9	Screwdriver for Allen key screws M6
10	Pipe wrench 27 mm
11	Tommy bar

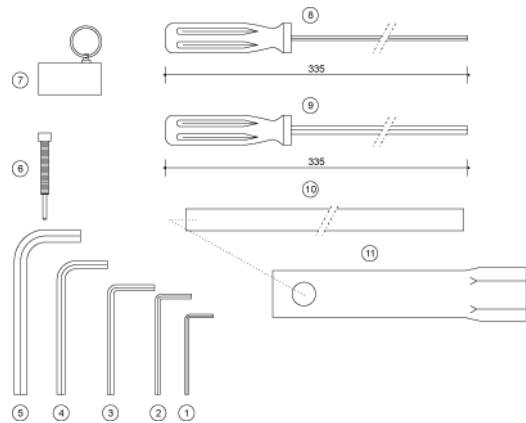

Figure 3.1 Tool set for 854 ATG (part no. 1854.062)

3.2.2 Installation of measuring drum

- Remove the drum compartment cover (rear cover).
- Check whether the drum shaft is properly positioned in the drum.
- Attach the smallest of the four test weights (or another small weight) to the measuring wire, remove the rubber band securing the measuring wire and feed the wire and test weight through the neck of the gauge (see figure 3.2).
- Insert the measuring drum onto its bearings.
- Check the axial free-play of the drum as follows:
Push the drum towards the magnet cap in such a way that the drum shaft meets the magnet cap. Release the drum. Bring the drum in a slight vibration. The drum and drum should now move towards you with a axial movement of minimum 1 mm and maximum 2.5 mm.
- Note the engraved drum circumference value on a piece of paper for later use. There are several numbers engraved on the measuring drum. The number you are looking for has a value of approximately 338 mm (for example: 338.028).

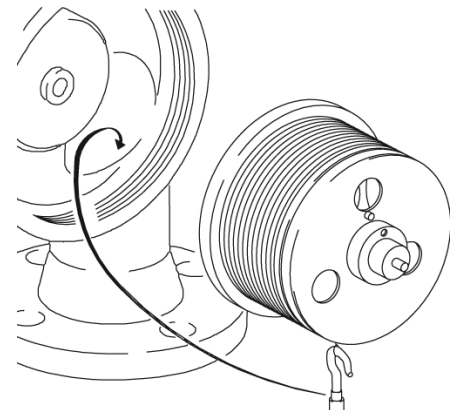

Figure 3.2 Installing drum shaft

3.2.3 Installation of displacer

- If a density displacer is used, note the engraved displacer weight and displacer volume on a piece of paper for later use.
- Remove the test weight and attach the displacer to the wire through a mounting hatch.

Note:

If there is no mounting hatch available, the displacer can be installed by temporarily removing the gauge from the nozzle.

To provide electrical contact between the measuring wire and displacer, thus permitting the discharge of static electricity and preventing loss of the displacer, the displacer must be secured to the measuring wire.

- Take an extra piece of wire and fasten one end to the measuring wire, pass the other end through the hole in the end of the displacer hook. Secure this end several times around the hook (see figure 3.3).
- Close the drum compartment cover.

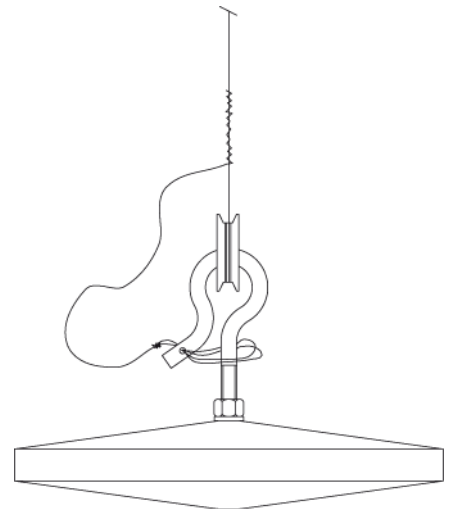

Figure 3.3 Mounting displacer

3.2.4 Unlocking (locking) the motor block

The motor block is locked during transport to protect the force transducer. After installing the measuring drum and displacer, the motor block locking device must be unlocked.

- Open the electronic compartment cover (front cover).
- Locate the transport bracket (see figure 3.4).
Loosen (do not remove) the Allen key screw and turn the transport bracket the opposite way. Use screwdriver for Allen key screws M4 (item 8 of the Honeywell Enraf tool set).
- Fix the Allen key screw of the transport bracket.
- Check the span wire. It should always be under tension while both ends are correctly positioned in the levers of the motor block and force transducer.
- Close the electronic compartment cover.

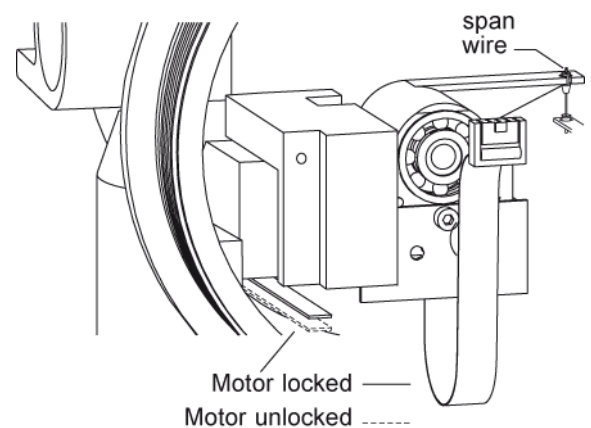

Figure 3.4 Motor block (un)locked

Note:

Use the same procedure for locking the motor block if the 854 ATG needs to be removed.

3.3 Programming (configuring) the gauge

3.3.1 Introduction into programming

The 854 ATG is a field-configurable multi-processor instrument. The instrument can be totally programmed out in the field, or remotely, without opening the gauge.

It is recommended to use an 847 PET (Portable Enraf Terminal) to load the different parameters. It is coupled to the 854 ATG via an infra-red coupling. The 847 PET is intrinsically safe and waterproof (IP65) and consists of a full ASCII membrane keyboard and an LCD display (refer to figure 3.5).

Alternatively, the Honeywell Enraf service tool Ensite can be used to configure the instrument. The Ensite program runs under MS- or PC-DOS 3.0 or higher. It is recommended to use the service tool to make a log file of the instrument. A log file contains all important settings and the information is stored on the hard disk (or diskette).

For more information, refer to the Instruction manual Ensite service tool.



Figure 3.5 Programming the 854 ATG by using The 847 Portable Enraf Terminal

The item concept

All parameters, settings, etc, are accessible via so-called items. These items all have unique 2-letter abbreviations which allow easy access and programming. In this manual, items are printed **bold**.

There are three different type of items:

Type of item	Description
Commands	These will force the gauge to execute a special task or function. For example: EX (exit). After the EX command the instrument start initialising and modified NOVRAM settings become active.
Data requests	Items for request of setup or measuring data from the gauge. For example: JS (jumper setting). Item JS returns the jumper setting on the XPU(-2) board. Some of the data items are read-only.
NOVRAM settings	All parameters which can be programmed and should not be lost after power break down, are stored in NOVRAM. The NOVRAM is a non-volatile RAM memory which does not require battery back up.

Data stored in NOVRAM can be protected by a password and by the Weights & Measures (W&M) jumper on the XPU(-2) board (refer to figure 3.6).

Protection levels are provided for all NOVRAM items, depending on the importance of an item. Protection level 1 is protected by password 1 (**W1**) and protection level 2 is protected by password 2 (**W2**). If the NOVRAM is protected by the W&M jumper J(A)3 level 2 NOVRAM items cannot be changed without opening the gauge, thereby breaking off the sealing. Most data requests and commands are not password protected.

Protection level 1

Access to items which are not directly measurement related, such as high level alarm (HA), tank identifier (TI), etc. is protected by password 1 (W1). It is possible to modify these data only after entering the correct level 1 password W1=XXXXXX, where XXXXXX is the level 1 password. Password W1 itself can be read protected by means of jumper J(A)1 on the XPU(-2) board.

Protection level 2

All NOVRAM items which affect the (remote) level reading, such as reference level (RL), transmission address (TA), etc. are protected by password 2 (W2). It is possible to modify these data only after entering the correct level 2 password W2=XXXXXX, where XXXXXX is the level 2 password. Additional measurement related items, such as temperature items, can also be protected by password 2. Password W2 itself can be read protected by means of jumper J(A)2 on the XPU(-2) board. In protection level 2, the items which resides under protection level 1 can also be modified.

W&M protection

Items under protection level 2 can also be protected by jumper J(A)3 on the XPU(-2) board. If this jumper is placed in position 1, the write access is completely disabled. Also issuing the correct level 2 password will not work.

The table below gives an overview of the XPU(-2) jumper functions (refer also to figure 3.6).

Jumper (XPU / XPU-2)	Function	Position "0"	Position "1"
JA1 / J1	read password 1	not protected	protected
JA2 / J2	read password 2	not protected	protected
JA3 / J3	W&M protection	not protected	protected
JA4	NOVRAM initialising	active	not active
JA5 - JA7 / J4 - J6	spare		

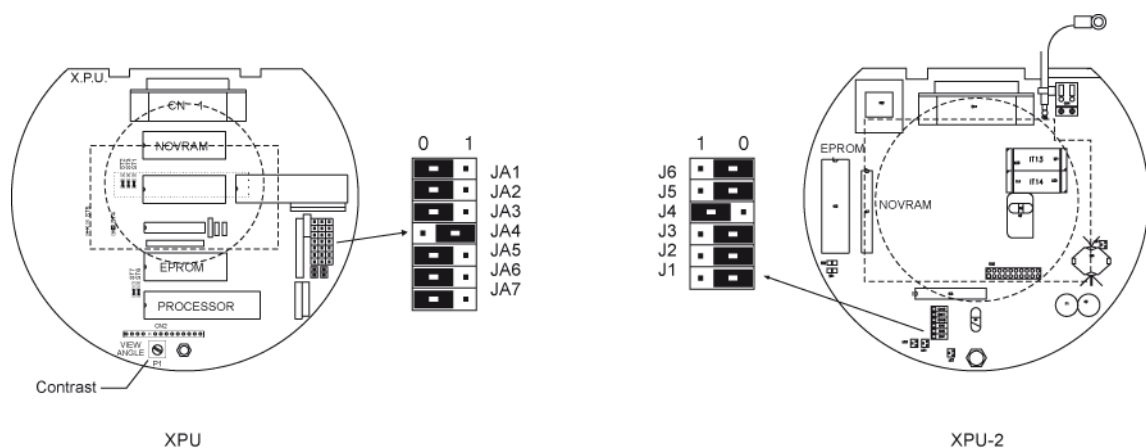

Figure 3.6 Jumpers on XPU and XPU-2 board

How to program?

When the 847 PET is plugged into the 854 ATG and the instrument is powered, the PET can be switched on. By operating the keyboard, items can be requested and settings can be changed.

For example:

Item (+ setting) (typing in on PET keyboard)		Description
RL	<enter>	Request for the current value of item RL (reference level). The reply on the PET display will be: RL+000.0000 This means: the reference level is: 0 metres.
W2=ENRAF2	<enter>	Enter protection level 2 (default level 2 password is: ENRAF2).
RL+=012.3400	<enter>	Give the required setting for the reference level (here, as an example: 12.34 metres).
EX	<enter>	Exit protection level 2. The 854 ATG will now initialise and the new entered value of the reference level will become active after the re-start.

Recommended programming sequence

The 854 ATG is already pre-programmed at the factory. However, several parameters, application depended, must be programmed at commissioning.

Step 1 Start with programming / checking of the format depended items (refer to section 3.3.3)

Step 2 Proceed with programming / checking of the items for the standard level measurement without optional functions (refer to sections 3.3.4 to 3.3.7).

Step 3 Check with the identification code on the label of your 854 ATG whether the gauge is equipped with one or more optional functions, and program the items for that options (refer to the appropriate option manuals).

3.3.2 Apply power to the 854 ATG

To program the gauge, power must be switched on. That should be done in this stage.

Note:

After the initialisation of the gauge, the displacer is moving down, because the default level setting is at 26 metres.

If the displacer movement is unwanted in this stage, issue the **FR** command by the PET. This action freezes the displacer position. This command must be repeated after each **EX** (exit) or **RS** (reset) command. The freeze command can be cancelled by the **UN** (unlock) command.

3.3.3 Selecting dimension and decimal separator

When one of the dimension items are changed, all items with related formats have to be changed and the values must be converted to the new dimension. The same applies for the decimal separator.

Note:

When the 854 ATG is equipped with an XPU-2 board (can be recognised by requesting the software version item **SV** reads: XPU ... Hx.x), then all dimension depended items will be automatically changed and the values will be automatically converted.

Item	Name	Description
W2=	Protection level 2	Enter protection level 2 (default password: ENRAF2)
LD=	Level dimension	<p>Selects and converts the level dimension. This item contains one character, which can be:</p> <p>M : metres; format: sign X X X separator X X X X F : feet; format: sign X X X X separator X X X I : inches; format: sign X X X X X separator X X P : fractions; format: sign X X ' X X " X X</p>
DP=	Decimal separator	<p>The item DP (decimal separator) can be:</p> <p>. : point or , : comma</p>
.. =	<i>format depended items</i>	<p>Not required with XPU-2 board. Program all level dimension and/or decimal separator depended items to the new dimension and/or separator. Refer to the table below for an overview of these items.</p>
EX	Exit protection level	

Items from which the format depends on the level dimension <i>and</i> decimal separator				Additional items from which the format depends on the decimal separator	
AH	HL	LP *)	MP *)	28 *)	M1 *)
AM *)	IL *)	LS *)	MZ	29 *)	M2 *)
AN *)	L2	MG *)	RL	DL *)	M3 *)
DB	L3	MH	RP *)	DU *)	O1 *)
DH	LA	MI *)	TT	H1 *)	O2 *)
DZ	LL	MK *)	UR	H2 *)	O3 *)
HA	LM *)	ML		H3 *)	PH *)
HH	LN *)	MO *)		HD *)	RO *)

*) The presence of these items depends on the installed option board

Standard floating point format

Some items are expressed in a floating point format. The floating point format is a fixed format;

- Standard floating point format: sign point M M M M M M M M E sign P P

where: M = Mantissa
 P = Exponent

3.3.4 Tank and gauge data

Refer to figure 3.7 for the tank related data.

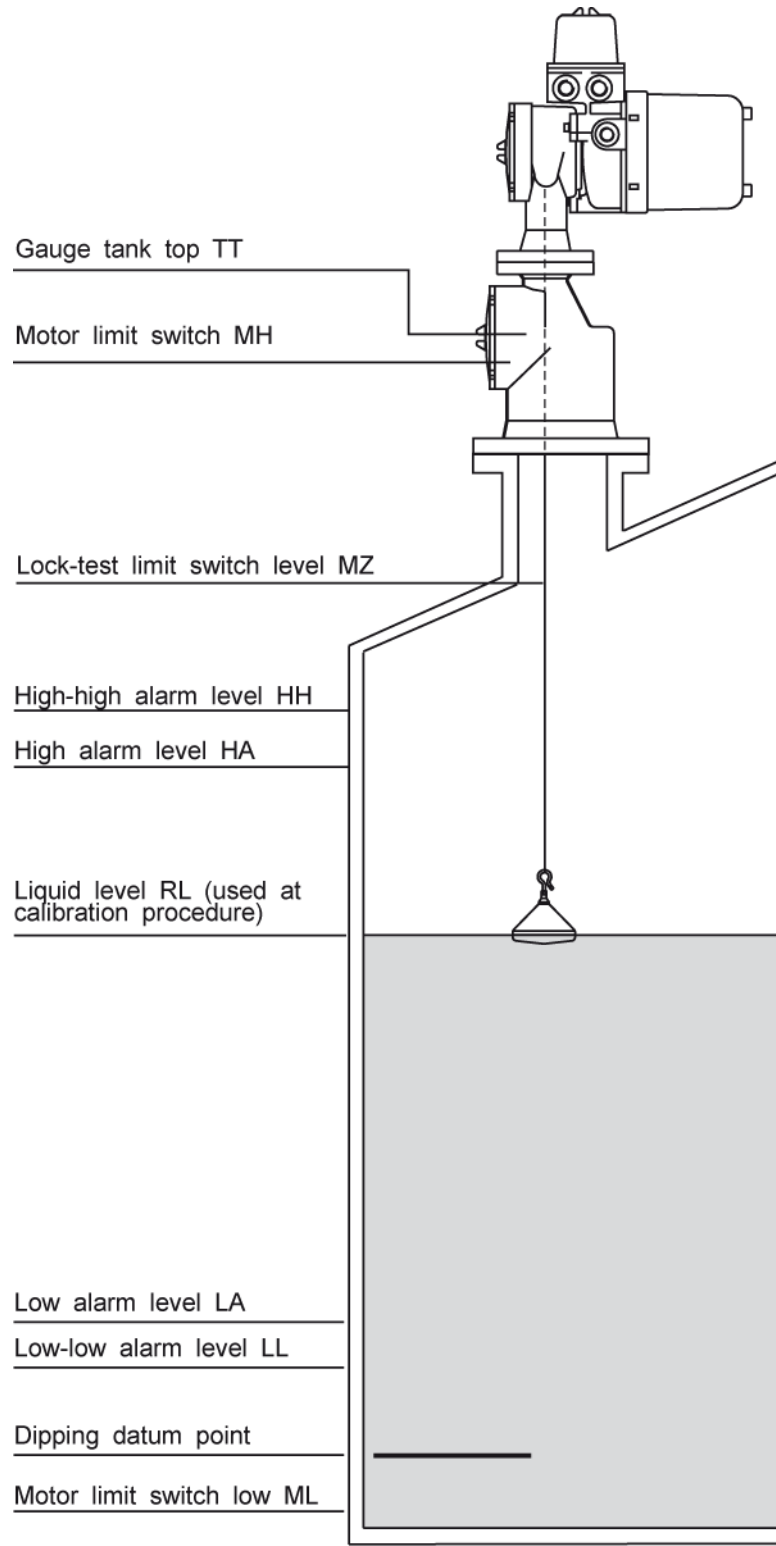

Figure 3.7 Tank related level items

Item	Name	Description								
W2=	Protection level 2	Enter protection level 2 (default password: ENRAF2)								
TT=	Tank top	Format according to item LD . The tank top level must be set for correct wire weight compensation. The value you enter now, is overwritten when the level calibration with displacer stop is used.								
MH=	Motor limit switch high	Format according to item LD . This is the highest allowed position for the displacer during normal operation.								
MZ=	Lock test limit switch level	Format according to item LD . Item MZ sets the highest displacer position during a lock test.								
ML=	Motor limit switch low	Format according to item LD . This is the lowest allowed position for the displacer during normal operation.								
DC	Drum circumference	Standard floating point format; units: metres. Check whether the pre-programmed drum circumference is in accordance with the engraved value of the installed measuring drum. If that is not correct, enter the engraved drum circumference.								
DW	Displacer weight	Standard floating point format; unit: grams. The standard displacers have a weight of 223 g. If a density displacer is used, check whether the engraved weight is programmed correctly in this item. If not, then enter the engraved displacer weight.								
DA	Displacer area	Standard floating point format; units: cm ² . Check whether the pre-programmed displacer area is in accordance with the used type of displacer. Refer to Appendix B for information on the displacer area values. If not correct, program the correct displacer area.								
S1	Set point	Standard floating point format; units: grams. With the standard displacers, the interface 1 set point (level surface) is set to 208 g. If a density displacer is used, program S1 as: (DW - 15).								
TA=	Transmission address	Two digits. The transmission address identifies the gauge on the Honeywell Enraf 2-wire field bus. Each gauge must have a unique address, and hence TA must be programmed differently. When connected to an 858 CIU, please note that the 858 CIU has three highways, containing the following transmission addresses:								
		<table border="1"> <thead> <tr> <th>CIU highway</th> <th>Transmission address (TA)</th> </tr> </thead> <tbody> <tr> <td>TL 1</td> <td>00 - 29</td> </tr> <tr> <td>TL 2</td> <td>30 - 59</td> </tr> <tr> <td>TL 3</td> <td>60 - 99</td> </tr> </tbody> </table>	CIU highway	Transmission address (TA)	TL 1	00 - 29	TL 2	30 - 59	TL 3	60 - 99
CIU highway	Transmission address (TA)									
TL 1	00 - 29									
TL 2	30 - 59									
TL 3	60 - 99									
TI=	Tank identifier	Six characters. Used as a label; the tank name can be programmed in the tank identifier item (spaces are not allowed!).								
TS=	Transmission speed	Four digits; either 1200 (default) or 2400. Units: baud								
GT=	Gauge type	One character. Represents the gauge type. For the 854 ATG, GT=B.								
EX	Exit protection level 2.	The gauge will now initialize and after start-up, the modified settings become active.								

Example:

On tank 102 is the nozzle height 21.350 m and the nozzle length is 300 mm. The displacer may not enter the nozzle. The maximum operating level is 19.1 metres. Because of sludge, the motor limit switch low must be set on 300 mm. A standard 90 mm carbon teflon displacer is used and the drum circumference is 338.025 mm. The gauge is connected to CIU highway TL1 and the address is chosen as 02. The level dimension is metres.

Item (+setting)		Description
W2=ENRAF2	<enter>	Enter protection level 2 (ENRAF2 is the default level 2 password).
TT=+021.3500	<enter>	Tank top is 21.35 metres.
MH=+021.0500	<enter>	Motor limit switch high set at $21.35 - 0.3 = 21.05$ metres.
MZ=+020.0000	<enter>	Lock test limit switch level is set between maximum operating level and MH .
ML=+000.3000	<enter>	Motor limit switch low set at 0.3 metres.
DC	<enter>	Check whether the drum circumference is correct; if not, change it.
DW	<enter>	Check whether the displacer weight is correct; if not, change it.
DA	<enter>	Check whether the displacer area is set correct; if not, change it.
S1	<enter>	Check whether the set point 1 is set correct; if not, change it.
TA=02	<enter>	The transmission address becomes: 02.
TI=TK-102	<enter>	Tank identifier programmed as TK-102.
TS	<enter>	Check whether the transmission speed is correct; if not, change it.
GT	<enter>	Check whether the gauge type is set correct; if not, change it.
EX	<enter>	Exit protection level.

3.3.5 Alarm settings

Refer to figure 3.7. The high level alarm (**HA**) and low level alarm (**LA**) conditions are transmitted to the host via the 2-wire Honeywell Enraf field bus (or optional RS-channel).

Item	Name	Description
W2=	Protection level 2	Enter protection level 2 (default level 2 password: ENRAF2).
AH=	Level alarm hysteresis	Format according to item LD . Sets alarm hysteresis.
HA=	High level alarm	Format according to item LD . High level alarm set point.
HH=	High high level alarm	Format according to item LD . High high level alarm set point.
LA=	Low level alarm	Format according to item LD . Low level alarm set point.
LL=	Low low level alarm	Format according to item LD . Low low level alarm set point.
EX Exit	Exit protection level.	

3.3.6 Ullage readout

When an ullage reading is required, the two items shown below must be changed.

The ullage value is also transmitted to the host via the 2-wire Honeywell Enraf field bus (or optional RS-channel).

The ullage, or outage, measurement is referred to a 'zero' point at the tank top (upper reference point).

The level, or innage, measurement is referred to a 'zero' point at the tank bottom (datum plate).

Refer to figure

Note:

*The high and low level alarms are "innage" alarms. Hence a **high alarm** condition occurs when there is a **low ullage** value and visa verse.*

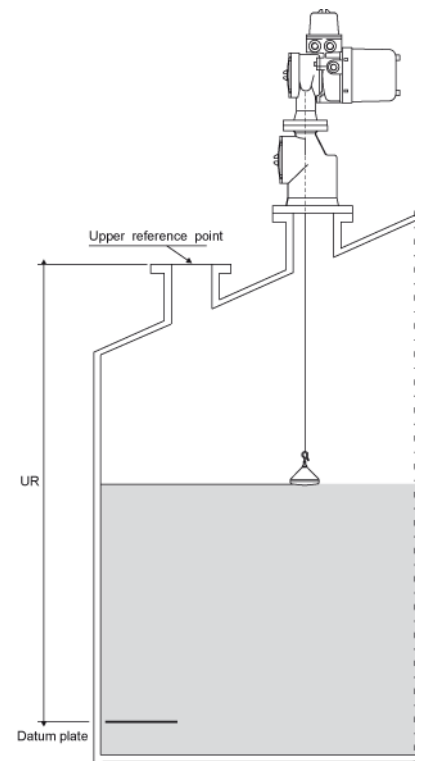

Figure 3.8 Upper reference value

Item	Name	Description
W2=	Protection level 2	Enter protection level 2 (default password: ENRAF2)
UR=	Upper reference	Format according to item LD . The distance UR represents the distance from the 'innage' zero point (datum plate) to the upper reference point at a dip hatch (or other point at the tank top).
DE=	Level type	One character; either C, I or U. C : for hydrostatic deformation compensated innage measurement I : for innage measurement (default) U : for ullage measurement
EXExit	Exit protection level.	

3.3.7 Display control and password protection

Item	Name	Description										
W2=	Protection level 2	Enter protection level 2 (default password: ENRAF2)										
DF=	Display format	<p>One character. Selects the data which will be shown on the XPU display (refer to Appendix D for a detailed overview).</p> <p>A : level and temperature B : level C : average gas temperature D : average product temperature E : HIMS density F : pressure P1 H : pressure P3 I : servo density J : analog level output K : water level from external HART probe (only with XPU-2)</p>										
DG=	Tenth millimetre selection	<p>One character. Only active when level dimension is metres.</p> <p>Y : for tenth millimetre indication N : for millimetre indication</p>										
DJ=	Zero format	<p>One character which selects how the number zero is displayed:</p> <p>0 : as an "0" with "slash" O : as a capital letter "O"</p>										
DY=	Display selection	<p>One character. Only applicable with XPU-2.</p> <p>Y : display connected N : no display connected</p> <p>Note: <i>When the display is present, but item DY is set to N, no data will be shown on the display.</i></p>										
W1=	Password 1	<p>Six characters, default password is: ENRAF1. You can define your own level 1 password by entering six characters. Password 1 is read protected if strap J(A)1 on the XPU(-2) board is in position '1'.</p>										
W2=	Password 2	<p>Six characters, default password is: ENRAF2. You can define your own level 2 password by entering six characters. Password 2 is read protected if strap J(A)2 on the XPU(-2) board is in position '1'.</p>										
WM=	Weights & Measures protection	<p>Four characters; either 'A' (feature W&M approved) or 'N' (feature not W&M approved). If the N is selected for a feature, the level dimension and level type on the display will be replaced by hashes: '### ##'.</p> <table border="1"> <thead> <tr> <th>Position</th> <th>Feature</th> </tr> </thead> <tbody> <tr> <td>1</td> <td>Product level (I1)</td> </tr> <tr> <td>2</td> <td>Interface 1 / interface 2 (I2)</td> </tr> <tr> <td>3</td> <td>Water level (I3, or external water probe)</td> </tr> <tr> <td>4</td> <td>Dip mode on interface 1</td> </tr> </tbody> </table>	Position	Feature	1	Product level (I1)	2	Interface 1 / interface 2 (I2)	3	Water level (I3, or external water probe)	4	Dip mode on interface 1
Position	Feature											
1	Product level (I1)											
2	Interface 1 / interface 2 (I2)											
3	Water level (I3, or external water probe)											
4	Dip mode on interface 1											
EX	Exit	Exit protection level.										

3.4 Level calibration

3.4.1 Standard level calibration

Make sure the displacer is at the liquid surface. Perform a repeatability test to ensure the displacer is on the product surface (refer to section 4.2).

Determine the product level by manual dipping. It is essential that the level is as stable as possible.

Note:

Make two or three manual dips and compare each reading to ensure the manual dip value is correct.

Item	Name	Description
W2=	Protection level 2	Enter the protection level 2 password
RL=	Reference level	Format according to item LD . Enter in this item the manual level.
AR	Accept reference	By giving this command, the level value entered in item RL , is accepted as product level and will be shown on the display.
EX	Exit protection level.	

3.4.2 Level calibration with a tank top reference stop

A tank top reference stop is a mechanical device that can hold the displacer at a reproducible position when the displacer is pulled up. This device is placed above the motor limit switch high position. An Honeywell Enraf tank adapter can be provided with such a facility.

- 1) Follow the procedure as described in section 3.4.1
- 2) Determine the tank top position; proceed as follows:

Item	Name	Description
W2=	Protection level 2	Enter the protection level 2 password.
CA	Calibrate	With this command the displacer is pulled up until it is halted against the tank top reference. Wait until the displacer is settled.
TT=	Tank top	Format according to item LD . Read the level value from the display and program that value in item TT .
EX	Exit protection level.	

For verification of the level calibration, refer to section 4.8.1.

3.4.3 Level calibration using the top of ball valve

If level dipping is not possible, the 854 ATG can be calibrated using the top of a ball valve as reference point. Proceed as follows:

Item	Name	Description
W2=	Protection level 2	Enter protection level 2 password
CA	Calibrate	The displacer will be raised until it stops against the flange of the level gauge.
<div style="border: 1px solid black; padding: 5px; background-color: #f0f0f0;"> <p>Caution <i>If a 45 mm displacer is used, stop immediately the Calibrate command as soon as the displacer is above the ball valve, followed by an FR (freeze) command.</i></p> </div>		
		<ul style="list-style-type: none"> ▶ Make sure the displacer is positioned above the ball valve. Close the ball valve.
UN	Unlock	Unlock the gauge and wait the displacer reaches the top of the ball valve.
		<ul style="list-style-type: none"> ▶ Calculate the immersion depth of the displacer at the product interface (for a 90 mm displacer use 3 mm; for a 45 mm displacer use 12 mm).
RL=	Reference level	Format according to item LD . Enter the position of the top of the ball valve with respect to the tank zero adding the immersion depth of the displacer at the product level.
AR	Accept reference	By giving this command, the level value entered in item RL , is accepted as level value and will be shown on the display.
EX	Exit protection level.	
CA	Calibrate	The displacer will now raise from the ball valve. Let it stop against the flange or give a FR (freeze) command.
		<ul style="list-style-type: none"> ▶ Open the ball valve.
UN	Unlock	Unlock the gauge. The displacer will now move down till it reaches the level.

For verification of the level calibration, refer to section 4.8.2.

3.4.4 Interface measurement

Interface 3 (**I3**) is used as product / water interface measurement (with interface 2 (**I2**) another interface can be measured). The set point **S3** has to be set to such a value that half of the displacer volume is immersed in the water and the other half of the displacer volume is immersed in the product. That can be calculated as follows (refer to figure 3.9 and to Appendix B for detailed displacer information):

$$S3 = DW - (\frac{1}{2}DV \times r_{product} + \frac{1}{2}DV \times r_{water}) \text{ [g]}$$

where:

- S3** : set point **I3** measurement [g]
- DW** : displacer weight [g]
- DV** : displacer volume [cm³]
- $r_{product}$: density of the product [g/cm³]
- r_{water} : density of water [g/cm³]

Example:

- Displacer #0815.343 : ø45 mm
- Displacer weight (**DW**) : 223 g
- Displacer volume (**DV**) : 105 cm³
- Volume lower conical part : 3.2 cm³
- Height lower conical part : 6 mm
- Density product : 0.9 g/cm³

$$S3 = 223 - (52.5 \times 0.9 + 52.5 \times 1) = 123.25 \text{ [g]}$$

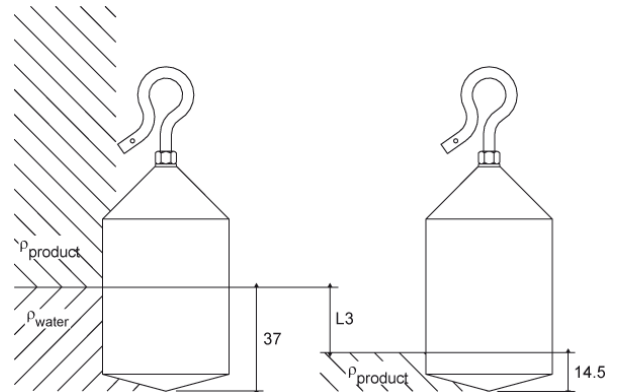

Figure 3.9 Calculation of set point

A level offset must be given as the displacer is now immersed for half of the volume in water. On product level the displacer is immersed less. The difference between both immersion depths must be given in item **L3**

Example:

- 1) Immersion depth on product level surface:
 - displaced volume : $(DW - S1)/r_{product} = 15/0.9 = 16.67 \text{ cm}^3$
 - volume in cylindrical part : $16.67 - 3.2 = 13.47 \text{ cm}^3$
 - immersion of cylindrical part : $13.47/\pi r^2 = 13.47/(\pi \times 2.25^2) = 0.85 \text{ cm} = 8.5 \text{ mm}$
 - immersion depth on product : $8.5 + 6 = 14.5 \text{ mm}$
- 2) Separation line product / water :
 - water volume in cylindrical part : $\frac{1}{2}DV - 3.2 = 52.5 - 3.2 = 49.3 \text{ cm}^3$
 - water height in cylindrical part : $49.3/\pi r^2 = 49.3/(\pi \times 2.25^2) = 3.1 \text{ cm} = 31 \text{ mm}$
 - separation line product / water : $31 + 6 = 37 \text{ mm}$ (from lower end of displacer)

Hence, level offset **L3** becomes : $37 - 14.5 = 22.5 \text{ [mm]}$

Item Name Description

W2=	Protection level 2	Enter protection level 2 password
S3=	Set point I3	Standard floating point format; units: grams. Set point for the product / water interface measurement.
L3=	Level offset I3	Format according to item LD . Level offset between interface 1 immersion depth (where the gauge is calibrated) and the product / water interface immersion depth.
EX	Exit protection level	

4 Operation

4.1 Display

The 854 ATG has an LCD display consisting of 2 rows of 16 characters each. On the display, one of several formats will appear, depending on the status of the XPU(-2). Immediately after power on the display is blank. Once the power is stable for 20 seconds, the display will show its initializing message.

If initializing of all processors is successful, the display will switch to its default display format, which is programmable with item **DF**.

The possible display formats are:

A	level and temperature	F	pressure P1
B	level	H	pressure P3
C	average gas temperature	I	average servo density
D	average product temperature	J	analog level output
E	HIMS density	K	water level from external HART probe (only with XPU-2)

Refer to Appendix D for an overview of the different display formats.

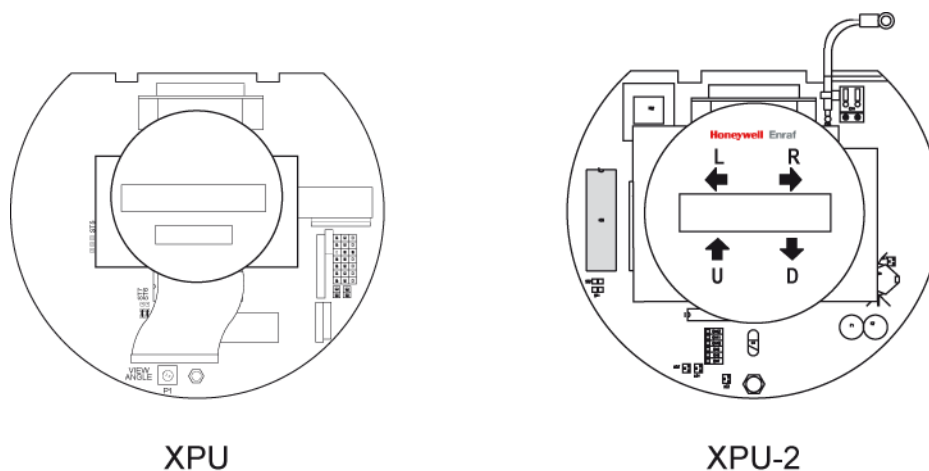

Figure 4.1 Display of XPU and XPU-2

4.1.1 XPU display

Display contrast

For best readability the viewing angle can be adjusted, using a small potentiometer on the XPU board, on the bottom left (refer to figure). Normally, it is adjusted in the factory for viewing horizontally.

Repeatability test

If the test magnet (item 7 of the tool kit) is hold for approximately 5 seconds in front of the rectangle block below the display, a repeatability test is performed. If the test magnet is hold for more than 8 seconds, a lock test is performed. The lock test function is cancelled when the magnet is removed.

4.1.2 XPU-2 display

Display contrast

Item **CD** allows the user to adjust the display contrast for maximum readability. **CD** can be set between 01 (minimum contrast) and 16 (maximum contrast). The display contrast can also be adjusted by means of the hall switches.

Additional displays

There are four hall switches located on the XPU-2 display, marked: “**L**”, “**R**”, “**U**” and “**D**” (refer to figure). These switches can be operated by holding a magnet in front of them (not the test magnet!).

Switch “**L**” allows scrolling through several additional displays. When an additional display is selected, further information can be requested by operating the other switches. After 3 seconds the display switches back to the standard display format (programmed by item **DF**).

The additional display gives information on:

- Display configuration
- NOVRAM item view
- XPU-2 error list
- System configuration
- Diagnostic view
- Test - Lock test - Unlock

The table on next page gives an overview of the additional display selections.

Function switch L	Additional display and function of other switches
1 st	Display configuration R display test (blank test / dark test) U display contrast up D display contrast down
2 nd	Display format toggle (formats A - K) U previous display format D next display format
3 rd	NOVRAM item view (all items) R fast forward U previous item D next item
4 th	Error list view (item EP) R fast forward U previous error D next error
5 th	System configuration (items: GT, TA, TC, TH, TI, TS, WM) U previous item D next item
6 th	Diagnostic view (items: 00, 03, EI, OS, OT, EJ, EP, FS, FH, FM, FT, FX, PF, XS, LC) U previous item D next item
7 th	Test gauge R test gauge U lock test D unlock

The steps of switch L can only be followed in the sequence as given in the table above.

Display scroll

The XPU-2 display can be configured to scroll automatically through all display formats. This is done by setting item **3Z** to enable.

Item	Name	Description
W2=	Protection level 2	Enter protection level 2 password.
3Z=	Toggle display format	With this item, the toggle display format function (display scroll) can be enabled or disabled. When enabled, all display formats are shown for approximately 2 seconds. E : enable toggle display format D : disable toggle display format
EX	Exit	Exit protection level.

4.2 Repeatability test

With the repeatability test the displacer is raised for approximately 75 mm (3") and then returns to the product surface. During the test, the level dimension and level type on the display are replaced by exclamation marks (!!! !!!) and the status field (I1) changes to TG. When the repeatability test is completed, the selected level dimension and level type appears and TG is replaced by I1.

Item	Name	Description
TG	Test gauge	Performs a repeatability test on the level measurement.

The level reading before and after the test may not differ more than 1 mm ($\frac{1}{16}$ ").

Note:

A repeatability test can also be performed by holding the magnet in front of the display. Refer to sections 4.1.1 and 4.1.2.

4.3 Lock test

The lock test command brings the displacer to the position, programmed in item **MZ** (lock test limit switch level).

During the lock test, the level dimension and level type on the display are replaced by exclamation marks (!!! !!!) and the status field (I1) changes to LT. When the lock test limit switch level is reached, the status field changes into BL (block).

Item	Name	Description
LT	Lock test	The Lock test raises the displacer to the programmed MZ position. Then the gauge goes into block mode (BL). If MZ is set higher than MH (motor limit switch high) the displacer stops at the programmed MH position.

The displacer will remain in one of these two positions until an unlock command (**UN**) is given.

Note:

A lock test can also be performed by holding the magnet in front of the display. Refer to sections 4.1.1 and 4.1.2.

4.4 Freeze and block commands

Both the freeze (**FR**) and block (**BL**) commands stops the displacer at the current position.

With the freeze command, the displacer remains in its position even when the level reaches the displacer position. Hence, the level can not be followed and the high and high high level alarms can not be generated.

The block command stops the displacer, and depending on how the block mode (item **BM**) is set, the displacer will move up with an increasing level, or the block is cancelled when the level reaches the displacer position.

Item	Name	Description
FR	Freeze	The displacer remains in its position even when the level reaches the displacer position.
BL	Block	The displacer stops at its present position, and depending on the status of item BM , the displacer will move up with an increasing level, or the block is cancelled when the level reaches the displacer position.

The displacer will remain in its position until an unlock command (**UN**) is given.

Item **BM** has to be set (checked) at commissioning (or at a later stage):

Item	Name	Description
W1=	Protection level 1	Enter protection level 1 password
BM=	Block mode	One character; either C (default) or N. C : Continuous; when the level reaches the displacer position, the displacer will follow the increasing level. N : Non-continuous; the block mode is cancelled when the level reaches the displacer position.
EX	Exit protection level	

4.5 Unlock

The unlock command (**UN**) cancels any of the following operational commands:

- Freeze (**FR**)
- Balance test (**BT**)
- Go up (**GU**)
- Go down (**GD**)
- Block (**BL**)
- Lock test (**LT**)
- Calibrate (**CA**)
- Test gauge (**TG**)

Item	Name	Description
UN	Unlock	The unlock command cancels the operational commands: BL , BT , CA , FR , GD , GU , LT and TG .

4.6 Interface measurement

The 854 ATG can measure three different interfaces. Interface 1 (**I1**) is normally used to measure the product level. Interface 3 (**I3**) can be used to measure the product / water interface. Interface 2 (**I2**) is a setting for a special measurement (i.e. interface between two product layers).

Item	Name	Description
I1	Interface 1	Interface 1 measurement (based on set point 1); normally used for product measurement.
I2	Interface 2	Interface 2 measurement (based on set point 2); setting for special measurement.
I3	Interface 3	Interface 3 measurement (based on set point 3); normally used for product / water measurement.

The default setting is on interface 1 (**I1**). If one of the other two interface measurements is selected, the gauge will remain on that interface measurement till the default measurement (**I1**) is selected.

4.7 Dip mode

When the gauge is in dip mode the displacer will be set at some distance (**DH**) above interface 1 (product surface). After a certain time (**DT**) a single product measurement is executed. After the interface has been measured, the displacer will be raised over the dip height (**DH**).

The level, shown on the display and transmitted to the host, will be the dipped level and not the actual displacer position.

Item	Name	Description
DM	Dip mode	Activates the dip mode. In dip mode the displacer is positioned at distance DH above the product and after a time interval DT , the product is dipped.

The dip mode is cancelled when one of the interface measurements is selected.

For the dip mode, items **DH** and **DT** have to be set (checked) during commissioning (or at a later stage):

Item	Name	Description
W1=	Protection level 1	Enter protection level 1 password
DH=	Dip height	Format according to item LD . In dip mode, the displacer is raised above the product over the dip height distance DH .
DT=	Dip time interval	Standard floating point format; unit: seconds. In dip mode, the interval time for the dip is specified in the dip time interval DT . Minimum value: 1 sec. maximum value: 32767 sec.
EX	Exit protection level.	

4.8 Verify level calibration

4.8.1 Verify level calibration against a tank top reference stop

When a tank adapter with a tank top reference stop is installed, the level calibration of the 854 ATG can be checked. Proceed as follows:

Item	Name	Description
CA	Calibrate	With this command the displacer is pulled up until it is halted against the tank top reference. Wait until the displacer is settled.
TT	Tank top	Request for the tank top value, which was established during level calibration. The level reading from the gauge should not differ more than ± 3 mm ($\pm 1/8$ "") with the value in item TT .
UN	Unlock	Give an unlock command to cancel the calibrate command.

If the tank top value and the gauge reading differs more than the specified value, the calibration procedure as described in section 3.4.2 should be repeated.

4.8.2 Verify level calibration on top of ball valve

If the top of the ball valve is used as reference point, the level calibration of the 854 ATG can be verified. Proceed as follows:

Item	Name	Description
CA	Calibrate	The displacer will be raised until it stops against the flange of the level gauge.
<div style="border: 1px solid black; padding: 5px; background-color: #f0f0f0;"> <p>Caution <i>If a 45 mm displacer is used, stop immediately the Calibrate command as soon as the displacer is above the ball valve, followed by an FR (freeze) command.</i></p> </div>		
		<ul style="list-style-type: none"> ▶ Make sure the displacer is positioned above the ball valve. Close the ball valve.
UN	Unlock	Unlock the gauge and wait the displacer reaches the top of the ball valve.
RL	Reference level	Request for the reference level value, which was established during calibration. The level reading from the gauge should not differ more than ± 2 mm ($\pm 1/16$ "") with the value in item RL .
CA	Calibrate	The displacer will now raise from the ball valve. Let it stop against the flange or give a FR (freeze) command.
		<ul style="list-style-type: none"> ▶ Open the ball valve.
UN	Unlock	Give an unlock command to cancel the calibrate command.

If the reference level value and the gauge reading differs more than the specified value, the calibration procedure as described in section 3.4.3 should be repeated.

4.9 Data items and operational commands

Below a summary of data items, error codes and operational commands.

Data items:

Item	Description	
CQ LQ UQ QS	Measured data	Compensated servo innage*) Servo innage Servo ullage Servo status request
BF BU BV BW FQ WQ	Control data	Average measured frequency Maximum unbalanced weight Minimum unbalanced weight Average measured weight Frequency request Weight request
EP ES	Error codes	Error XPU request Error SPU request

*) Compensated for hydrostatic tank deformation (items: **HF**, **HL**).

Operational commands:

Item	Description	Item	Description
BL	Block	I2	Interface 2
BT	Balance test	I3	Interface 3
CA	Calibrate	LT	Lock test
DM	Dip mode	MF	Measure frequency
FR	Freeze	TG	Test gauge
I1	Interface 1	UN	Unlock

5 Maintenance

5.1 Preventive maintenance

Whether maintenance is needed can be checked with the following tests:

Repeatability test (refer to section 4.2).

If repeatability deteriorates (more than 1 mm) the drum bearings should be replaced (refer to section 5.3.3).

Balance test

The measuring drum unbalance can be measured by the following procedure:

Item	Name	Description
LT	Lock test	Raise the displacer for approximately 0.6 m (2 ft) above the product level.
FR	Freeze	Stop the lock test and wait till the displacer is in a complete rest (one or two minutes).
BT	Balance test	With this command the balance of the measuring drum is checked. This measurement takes approximately 5 minutes. When the balance test is ready, the status on the display changes from BT into FR.
BU	Maximum unbalanced weight	Standard floating point format; units: grams. Request for the maximum unbalanced weight.
BV	Minimum unbalanced weight	Standard floating point format; units: grams. Request for the minimum unbalanced weight.
UN	Unlock	Cancel the lock test command.

Calculate the maximum measuring drum unbalance as: (**BU** - **BV**).

The drum unbalance should be within 3 grams. When the drum unbalance is more, check for contamination of the drum. If the unbalance is still more than 3 grams replace the drum bearings (refer to section 5.3.3).

Displacer weight

The weight of the displacer can be measured with the following procedure:

Item	Name	Description
LT	Lock test	Raise the displacer for approximately 0.6 m (2 ft) above the product level.
FR	Freeze	Stop the lock test and wait till the displacer is in a complete rest (one or two minutes).
MF	Measure frequency	Measure the frequency of the force transducer. It is ready when the status on the display changes from MF into FR.
WQ	Weight request	Standard floating point format; units: grams. Request for the displacer weight.
UN	Unlock	Cancel the lock test command.

Clean the displacer when the displacer's weight differs more than 3 g from the value in item **DW**, or recalibrate the force transducer with the test weights (refer to section 5.5).

For replacement of the printed circuit boards, motor block or force transducer (refer to section 5.4.2). After replacement of force transducer or motor block the force transducer requires re-calibration (refer to section 5.5).

Caution

The 854 ATG is an explosion proof instrument with intrinsically safe output/input circuits. Modification to the instrument may only be carried out by trained personnel which is authorized by Honeywell Enraf. Failure to adhere to this will invalidate the approval certificate.

5.2 Instrument covers

Opening the instrument

The joints between each cover and the housing are waterproof IP65. For this purpose the covers of the servo, drum compartment and terminal compartment are fitted with O-rings (refer to figure 5.1 and 5.2). Use a metal rod (like a tommy bar) for opening the covers.

Check the O-rings to assure water and dust protection. Refer to Appendix A for the dimensions of O-rings.

Closing the compartment covers

In order to ensure that the covers open easily, their screw threads have been greased.

Caution

Keep screw threads free from dirt. Grease them lightly with an acid-free grease before closing the instrument. When closing, turn the covers counter-clockwise until the thread clicks into place, then turn clockwise.

5.3 Drum compartment

5.3.1 Detailed description

Figure 5.1 shows the cross-section of the drum compartment of the medium pressure version and identifies the components. Figure 5.2 shows the chemical and high pressure version.

The drum shaft, mounted in the drum with a tolerance ring, is inserted into the magnet cap. Two carbon PTFE bearings in the drum shaft bushing support the drum shaft. These bearings should be replaced when repeatability deteriorates.

The drum shaft bushing is kept in position by a circlip. The drum shaft bushing is provided with an internal thread which facilitates removal from the magnet cap.

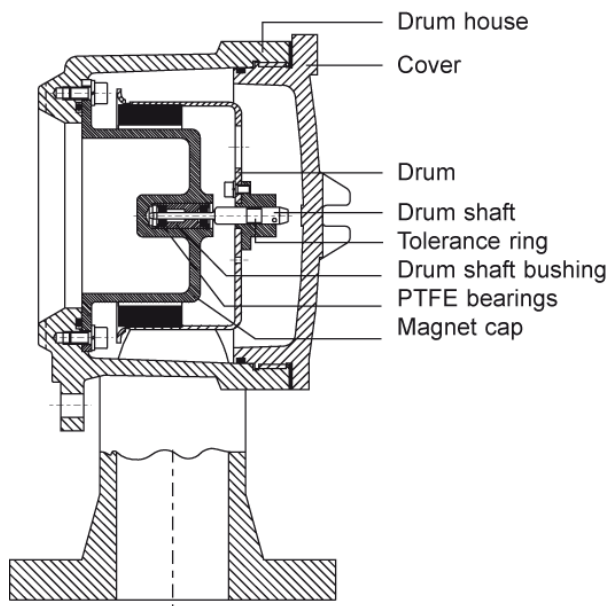

Figure 5.1 Cross section of the drum compartment 854 ATG medium pressure version

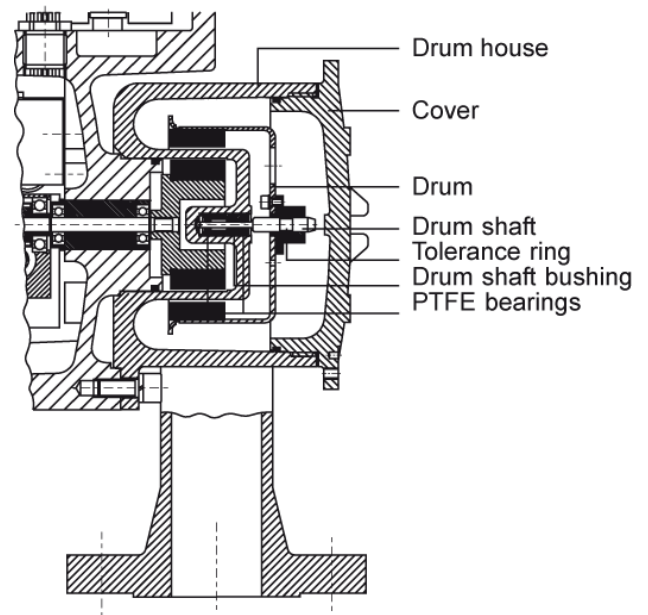

Figure 5.2 Cross section of the drum compartment 854 ATG High pressure version and Chemical version

5.3.2 Removing the measuring drum

Removing the drum from the housing requires no tools. Keep the drum, the outer magnet and the outside of the magnet cap thoroughly clean.

To remove the drum proceed as follows:

- Issue the **CA** (calibrate) command to raise the displacer
- If applicable close the ball valve and release the pressure gently.
- Give **UN** (unlock) command to lower the displacer from tank top position.
- Issue a **FR** (freeze) command when the displacer comes within reach.
- Switch-off the mains.
- Remove the drum compartment cover.
- Remove the displacer from the measuring wire. Attach a small weight on the wire to keep it positioned in the groove. Do not damage the measuring wire.
- Pull out the drum and fix the wire to the drum with a rubber band.
- Do not kink the measuring wire and handle drum carefully.

If the displacer cannot be accessed through an opening the gauge must be removed from its mounting position:

- Raise the displacer to maximum height, at least above the ball valve, when present.
- Switch-off the mains.
- If applicable close the ball valve and release the pressure gently.
- Remove the drum compartment cover.

Take off the 854 ATG, raising the displacer above the connecting flange.

- Remove the displacer from the measuring wire.
- Pull out the drum and fix the wire to the drum with a rubber band.

5.3.3 Replacing the drum bearings

- Open the drum cover.
- Take out the drum shaft bushing.
- Replace the bearings, refer to figure below
- Install the bushing.
- Install drum and displacer.
- Close the cover.

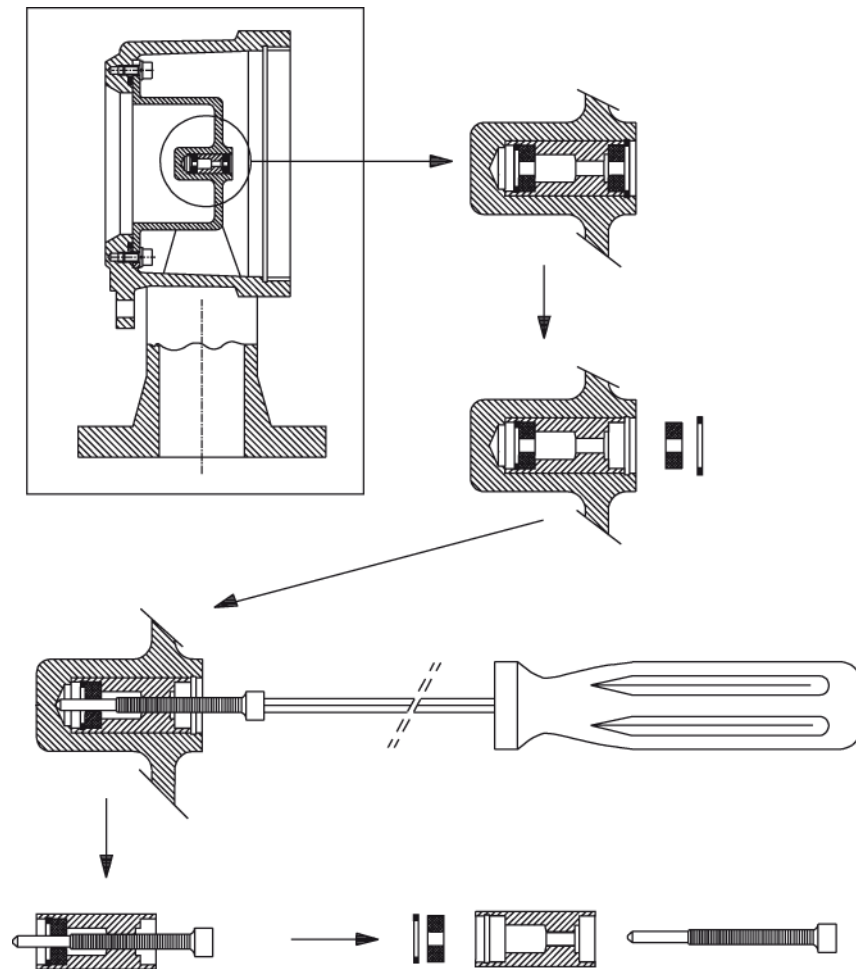

Figure 5.3 Replacing the drum shaft bearings

Caution

Do not grease the carbon PTFE bearings. The drum bearings do not require any lubricant at all.

5.4 The electronic compartment

5.4.1 Detailed description

The electronic part of the 854 ATG requires no special maintenance.

However, a detailed description of the combination of the several parts is given in order to help you in case of software-updates or system enhancements.

Caution

*Never remove the electronic boards when the mains power is connected to the gauge.
It may damage the electronic circuits.*

The control hardware is concentrated in the electronic compartment, which contains a minimum number of sub-assemblies. The design of the 854 ATG is such that it makes replacement and service simple.

The electronic compartment contains the following sub-assemblies (refer to figure 5.4):

- 1 Back-plane
- 2 Printed circuit board XPU
(Xmission Processing Unit)
- 3 Printed circuit board SPU
(Servo Processing Unit)
- 4 Printed circuit board
(Optional board: HCU)
- 5 Printed circuit board GPS
(Gauge Power Supply)
- 6 Force transducer
- 7 Stepper motor frame including encoder disc

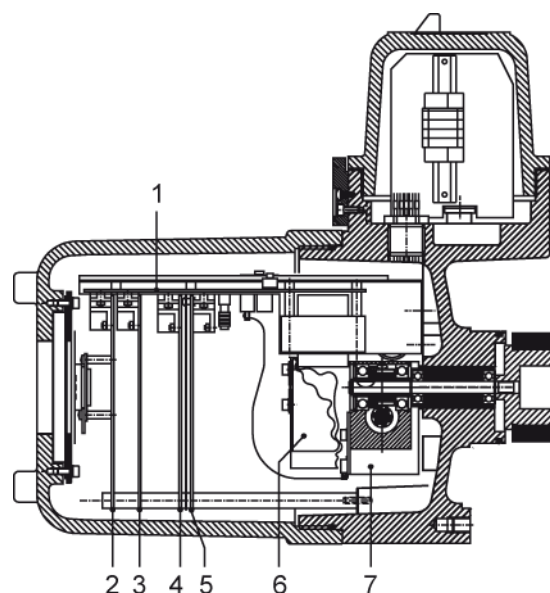

Figure 5.4 Cross section of the electronic and terminal compartment

5.4.2 Dismantling the electronic compartment

Note:

Whenever the force transducer and/or motor unit have been removed the force transducer must be recalibrated (refer to section 5.5).

To remove the various components proceed as follows:

- Switch off the mains and remove the cover from the electronic compartment.
- Remove the PCB retaining screw (B), slide the locking latch (A) on the XPU board to the right (refer to figure).
- Remove the XPU board and the SPU II board.
- Disconnect non i.s. wiring from the option board, and put the board temporarily on the back-plane (still connected via ground wire and blue i.s. wires).
- Remove the GPS board.
- Remove the PCB hexagon support bar.
- Secure the motor frame with the transport bracket (refer to section 3.2.4).
- Remove the flat cable connecting the motor block to the back-plane.
- Disconnect the force transducer cable.
- Remove the two screws holding the force transducer by lifting it slightly in order to release the span wire from the

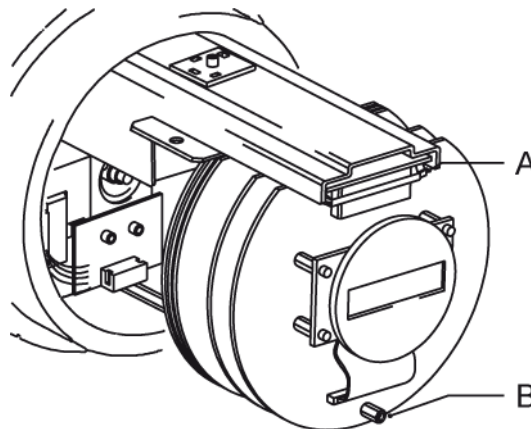

Figure 5.5 Locking latch

Caution

If the motor block needs to be removed, first remove the measuring drum (refer to section 5.3.2).

- force transducer.
- Disconnect the infra-red connector from the back-plane.
- Remove the circlip from the main shaft.
- Gently remove the motor from its shaft and remove the key.

If the back-plane must be replaced, proceed as follows :

- Disconnect the mains and transmission cabling from the back-plane
- Cut the tie -wraps retaining the wires.
- Unscrew and remove the four screws securing the back-plane frame, then remove the back-plane frame.

Assembly is done in reverse order.

Repair of the 854 printed circuit boards

Field repair of the electronic boards is not advised.

The components that can be replaced in the field are EPROMs and NOVRAM, see section 5.4.3 for updating software versions. Consult the service department of Honeywell Enraf.

5.4.3 Replacing software

The actual software version can be withdrawn by requesting for item **SV**. Compare the combination of the software versions of the XPU, SPU and optional board with the value of **SV** in the 'set-up and maintenance form' sent with every gauge.

Such a form, containing all the gauge and tank data, should always be available. Else, do commissioning, and fill-out the form before changing any EPROM or NOVRAM.

Moreover, check before changing, if the combination of the software in EPROMs, located on the various printed circuit boards, is compatible with your new software version. Carefully read the instructions which are enclosed with the new EPROMs or NOVRAM.

Refer to section 5.4.2 for dismantling the electronic compartment and removing the boards.

Note:

After installing an EPROM from a new software version the NOVRAM must be reformatted and the parameters of the gauge has to be reprogrammed. If the set-up / maintenance data is lost, go back to section 3.3.

Appendix E gives the layout of the different printed circuit boards with the position of the EPROMs and NOVRAM.

5.4.4 Initializing NOVRAM

If a new software version is installed, or a feature has been added to the 854 level gauge, NOVRAM initialization is required. With this procedure, all items are declared in the NOVRAM and filled with their default value. After the initialization, reprogramming of all items is necessary.

When the 854 ATG is equipped with an XPU board, the NOVRAM is initialized as follows:

- Switch off mains supply.
- Open electronic compartment of the gauge.
- Switch over strap JA4 on the XPU board to position 0.
- Close electronic compartment.
- Apply mains supply to the gauge.
- A NOVRAM initializing message is shown on the display.
- Hold the test magnet in front of the display.
- When the message: "NOVRAM init completed" appears, switch off mains supply.
- Open electronic compartment of the gauge.
- Switch over strap JA4 on the XPU board to position 1.
- Close electronic compartment.
- Apply mains supply to the gauge.

Alternatively, and for the XPU-2 **the only**, the following procedure can be used:

When the gauge is powered, issue the **IN** command by the PET 3 times in sequence. After the first command, use the "c" key and "enter" key. No other command may interfere in this sequence.

Note:

To prevent other commands in the initialization sequence, the Honeywell Enraf field bus lines may, temporary, be disconnected.

5.5 Calibrating force transducer

After mounting a new force transducer or another motor-block the force transducer must be calibrated. The frequency of the force transducer must be calibrated with help of a set of accurate test weights of 25 g, 75 g, 150 g and 225 g, all ± 0.1 g.

Check the mounting of the 854 ATG whether it is stable and horizontal.

Use the following procedure for calibration. It is assumed that the 854 ATG is fully operational. Calibration of an incompletely checked and reprogrammed gauge is not advisable.

If there is no inspection hatch, try to mount the gauge sideways, next to the original 2" flange. Check the availability of ample room to suspend (and move) the test weights (about 60 cm downwards should be sufficient).

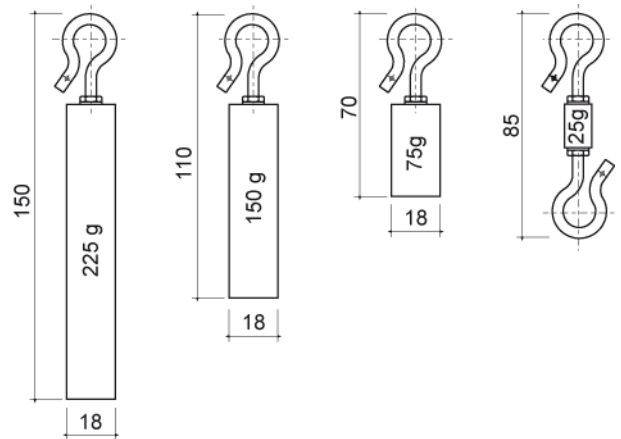

Figure 5.6 Set of test weights (#1854.061)

Force transducer calibration procedure

Item	Name	Description
W2=	Enter protection level 2	Enter protection level 2 password.
WT=	Wire rupture	Disable the wire-rupture, by setting WT to DDD. This prevents that under certain circumstances the 25 g calibration will be aborted.
EXExit	Exit protection level, which de-activates the wire rupture.	

Remove the displacer from the measuring wire and attach the smallest test weight of 25 grams.

Item	Name	Description
LT	Lock test	Raise the displacer as high as possible until it is in full view, and good accessible.
FR	Freeze	Send a freeze command to stop the displacer movement. Correct, if necessary temporarily the motor limit high setting MH , in such a way that the gauge will automatically return to this level after a lock-test command LT .
BT	Balance test	Start a balance test. The 854 ATG will measure and calculate an average frequency at 25 g over one full drum revolution. This measurement will take approximately 5 minutes.
BF	Average measured frequency	Standard floating point format; unit: Hz. Request the average measured frequency BF after completion of the balance test and note this value for F0 . The display will show a BL (block) or FR (freeze) in the lower right corner of the display.

Do not yet reprogram this value in the gauge. Reprogram all values after completion of all the four calibration measurements. Repeat this calibration from item **BT** for the other 3 test weight combinations:

- for **F1** with: (25+75 g),
- for **F2** with: (25+150 g),
- for **F3** with: (25+225 g).

Remove the test weights from the measuring wire and attach the displacer. Program the measured frequencies :

Item	Name	Description
W2=	Protection level 2	Enter protection level 2 password.
F0=	Frequency constant 0	Standard floating point format; unit: Hz. Program frequency 0, measured with test weight of 25 g.
F1=	Frequency constant 1	Standard floating point format; unit: Hz. Program frequency 1, measured with test weight of 100 g.
F2=	Frequency constant 2	Standard floating point format: unit: Hz. Program frequency 2, measured with test weight of 175 g.
F3=	Frequency constant 3	Standard floating point format; unit: Hz. Program frequency 3, measured with test weight of 250 g.
WT=	Wire rupture	Three characters. Reprogram wire tension protection (advised setting: EDE).
EX	Exit protection level.	

Note:

*A faster method of calibration is using the commands **MF** and **FQ** in stead of **BT** and **BF**. This method may not be followed when your gauge is used for density measurement via the density displacer.*

5.6 Synchronizing the reference encoder

After the installation of a new motor block or in case of mounting new software, the internal reference encoder must be synchronized to the position of the reference encoder and the gauge starts with an error code e.g. ES553 / ES555. The following procedure will do.

Item	Name	Description
W2=	Protection level 2	Enter protection level 2 password.
SM	Set maintenance	Go into maintenance mode and do not enter any command which is not specified below.
FP	Find position	The 854 ATG finds its encoder position. Wait appr. 20 seconds.
SO	Set operational	Restart in operational mode.
EX	Exit protection level and go back to operational mode.	

The gauge is now ready for level calibration (refer to section 3.4).

6 Trouble shooting

The 854 ATG is an instrument with self diagnostics. Detected errors will be shown as status information on the display (refer to Appendix D), or can be requested as items by the PET.

The following items contain the error codes of the processor boards:

- EP**Error XPU(-2) request (communication processor unit)
- ES**Error SPU request (servo processor unit)

These items contain an error code of the last error condition. The error codes can be read as long as the gauge is not reset.

Besides the error codes, data items from level and optional functions (such as temperature and analog level output) contain one or more status bytes which also give valuable information. These bytes are readable ASCII characters. However, most of them are bit coded. Appendix C contains an ASCII table for conversion of the status bits into the actual status.

An example for a bit coded status byte:

one (of the) status byte(s) reads: **F**;
 written out in bits (refer to Appendix C): **0100 0110**;
 (b7=0, b6=1, b5=0, b4=0, b3=0, b2=1, b1=1, b0=0).

Bit 7 is always a '0' and bit 6 is always a '1' to avoid 'control' characters.

Look up the relevant status byte in this section (e.g. **QS** in section 6.4) to determine the meaning of the bits which are set to '1'. Only the bits set to '1' represent an actual status.

6.1 Problems with displacer movement

If the displacer is not running freely, for instance stuck against a stilling well, it can be controlled manually.

Note:

Be aware that measuring wire is unrolled from the measuring drum. When the measuring wire is not kept at tension, the result will be an uncontrolled wire movement which results in the worst case in the lost of the measuring wire.

Item	Name	Description
W2	Protection level 2	Enter protection level 2 password.
SM	Set maintenance	Go into maintenance mode.
GD	Go down	Go down for approximately 200 mm (8").
FR	Freeze	Give the freeze command.
SO	Set operational	Exit maintenance mode
EX	Exit protection level 2	

When hereafter the displacer is free and the weight is too high, the force transducer must be recalibrated. When the measured displacer weight is too far out of range, the gauge is probably not levelled within 2°. Then, improve the stability of the construction on which the gauge is mounted.

6.2 XPU error code (item EP)

The XPU error code is a three-digit number. When the XPU detects an error about a certain item, that item follows the error code, separated by a space.

For instance: 067 LL : invalid level format in item LL.

Some XPU error codes of item **EP** are listed below, with suggestions for solving the problem. For a complete overview, refer to “Item documentation for Honeywell Enraf series 854 ATG“ and in the item help of the service tool Ensite.

000	No error	
011	NOVRAM version error	New software is installed; requires NOVRAM initialization
014	NOVRAM operation error	Set item 03 to '@'; check all settings, there may be an error
017	NOVRAM init failed	NOVRAM seize too small. Use XPU-1 board with larger NOVRAM seize
021	SPU start-up failure	SPU board not well connected in backplane, or defective.
033	SPU fatal error	SPU board not well connected in backplane, or defective.
036	Jumper setting changed	Jumper setting changed while power was on. Give reset (RS) command.
040	Missing SPU board	Missing SPU board or board not well connected in backplane, or defective.
051	Unknown item	Item not known to 854 ATG, check for correct item.
053	Invalid item length	Wrong data field length, check for correct item setting.
056	Wrong protection level	First enter protection level 1 or 2.
067	Invalid level format	Check item LD , then give the setting in the correct level format.
071	Invalid decimal separator	Check item DP , then give the setting with the correct decimal separator.
076	Invalid floating point format	Give the setting in the correct floating point format (refer to section 3.3.3).
081	Command disabled by HC	Command is currently disabled by the host command (HC)
082	Invalid password	Give the correct password for W1 and W2 .
096	Password read not allowed	Password read access not allowed
101	Watchdog error	The watchdog reset is a sign that there is a serious fault, caused by interference, or a faulty XPU board.
136	SPU board not responding	Missing SPU board, or SPU board not well connected in backplane, or SPU board defective.
137	Optional board not responding	Missing optional board, or optional board not well connected in backplane, or optional board defective.
999	Fatal XPU error	Serious internal XPU software error; check contents of item 00 and report to Honeywell Enraf Delft.

6.3 SPU error code (item ES)

The SPU error code is a four-digit number. Some SPU error codes of item **ES** are listed below, with suggestions for solving the problem. For a complete overview, refer to “Item documentation for Honeywell Enraf series 854 ATG“ and in the item help of the service tool Ensite.

0000	No error	
0104	F0 range error	Frequency constant 0 value is out of range (probably after NOVRAM init). Give correct setting in item F0 , or calibrate force transducer (refer to section 5.5).
0407	Force transducer initialisation error	The force transducer does not start-up correctly, or the motor unit has not been unlocked.
0553	Reference encoder error 1	A minimum correlation between the reference encoder table and the values read from the actual reference encoder is not achieved. Either stepper motor or the reference encoder is defective or filthy. Check motor and reference encoder (excessive oil?).
0554	Reference encoder error 2	
0555	Reference encoder error 3	Motor slack of more than ¼ revolution appeared. Recalibrate the gauge.
0601	Force transducer error 1	Frequency of the force transducer is too low
0602	Force transducer error 2	Frequency of the force transducer is too high
0605	No wire tension	A wire rupture was detected or the motor unit has not been unlocked, or the force transducer is defective.
0610	Wire tension too low	The wire tension has been too low for a while. Solve the problem or adjust item ML .
0611	Wire tension too high	The wire tension has been too high for a while. Solve the problem; clean the displacer.

6.4 SPU status request (item QS)

The servo status request (item **QS**) consists of four bytes. Bytes 0, 1 and 2 are bit coded with information about the level alarms, operational mode and general status. Byte 3 is an ASCII character that indicates the active operational command.

Status byte 0:

- bit 0 : low level alarm
- 1 : low low level alarm
- 2 : high level alarm
- 3 : high high level alarm
- 4 : motor limit switch low
- 5 : motor limit switch high
- 6 : 1
- 7 : 0

Status byte 1:

- bit 0 : displacer movement down
- 1 : displacer movement up
- 2 : on level
- 3 : test flag
- 4 : calibration test successful
- 5 : calibration test failed
- 6 : 1
- 7 : 0

Status byte 2:

- bit 0 : Active interface bit 0
- 1 : Active interface bit 1
- 2 : dipped level
- 3 : 0
- 4 : general fail indication
- 5 : no previous **ST**, **WD** or **SD** command
- 6 : 1
- 7 : 0

Active interface:

bit 1	bit 0	Mode
0	0	I1
0	1	I2
1	0	I3
1	1	dip

Status byte 3:

- | | |
|-----------------------|-----------------------|
| - : no command active | N : interface profile |
| A : balance test | L : lock test |
| B : Block | M : measure frequency |
| C : calibrate | R : tank profile |
| D : go down | T : test gauge |
| F : freeze | U : go up |

Appendix A Article and part numbers

No.	Description	Part no.
1	circlip	2147.205
2	drum with 27 m stainless steel wire + shaft and circlip	0854.962
3	drum shaft	0185.441
4	screw + ring 6 pcs	0854.941
5	screw + ring 3 pcs	0854.942
6	seal assembly cpl.	0854.943
7	key	6576.001
8	ground lip + screw + ring	0854.945
9	kit containing higher terminal set + compartment cover + terminals	0854.960
10	gasket 132 x 112.2 x 1 all versions (gauges from November 1993: O-ring \varnothing 117 x 3, material NBR)	2135.255 2132.977
11	terminal AKZ4.Q2.5 (grey)	2635.308
12	terminal AKZ4 (blue)	2635.309
13	4 wire cable bushing	0854.946
	8 wire cable bushing	2695.241
	10 wire cable bushing	0854.947
14	lock bracket with screws for medium pressure 854 ATG	0854.948
15	GFC option board for Foundation™ Fieldbus Communication	0690.806
16	support bracket for backplane ass.	0185.600
17	GPS printed circuit board	0854.615
	fuse 250 mA, 250 V	2655.169
	fuse 1 A, 250 V	2655.175
18	back-plane assembly (including transformer 110,130,220,240 V)	0854.951
	back-plane assembly (including transformer 240, 65 V)	0854.964
19	HCU optional printed circuit board for:	
	VITO temperature and/or water probe	0854.930
	VITO temperature and/or water probe + HART device(s)	0854.931
	Spot temperature Pt100 RTD	0854.932
	Spot temperature Pt100 RTD + HART device(s)	0854.933
	Analog level output	0854.935
	Analog level output + VITO temperature and/or water probe	0854.936
	Analog level output + VITO temperature	0854.937
	Analog level output + Spot temperature Pt100 RTD + VITO temperature and/or water probe + HART device(s)	0854.934
20	SPU printed circuit board without hardware alarms	0854.611
	SPU printed circuit board with hardware alarms	0854.612
	EPROM programmed for SPU1 standard	0181.170
	EPROM programmed for SPU1 servo density	0181.171
	EPROM programmed for SPU2 alarms	0181.172
	EPROM programmed for SPU2 alarms + servo density	0181.173

No.	Description	Part no.
21	NOVRAM XPU-2 board	2518.929
	XPU-2 printed circuit board for water bottom measurement	0873.620
	XPU-2 printed circuit board with i.s. connection to 977 TSI	0873.621
	XPU-2 printed circuit board with RS-232C communication channel	0873.623
	XPU-2 printed circuit board with RS-485 communication channel	0873.624
	EPROM programmed for XPU-2 (all options)	0181.176
26	PCB support screw M4 x 70	6215.067
27	span wire cpl.	0854.151
28	force transducer	0854.956
29	screw and ring 2pcs	0854.965
30	electronic compartment cover cpl.	0854.952
	anti seize grease	4000.015
31	motor board	0894.601
32	motor assembly	0854.957
33	hex spacer	0185.606
	+ matching adjust. screw M4 x 16	6451.055
34	transport bracket	0185.762
35	ball bearing	2100.418
36	O-ring NBR 3.0 x 179.5	2132.970
37	IR connector (chassis part)	0854.380
38	O-ring NBR 3.53 x 66.27	2132.617
39	displacer, material PTFE (25% carbon)	
	45 mm	0815.343
	90 mm	0815.344
	110 mm	0815.345
	other sizes and material displacers are available	
40	measuring wire, 30 m stainless steel	0802.801
	other lengths and materials are available	
41	O-ring FPM 3.53 x 98.02	2132.972
42	magnet cap	0186.060
43	set drum bearings	0854.953
44	O-ring SIL/FEP 3.0 x 134.5	2132.975
45	gasket 165 x 141.7 x 1 MEDIUM PRESSURE (up to November 1993)	2135.257
	O-ring ø 145 x 3 material NBR (gauges from November 1993)	2132.978
46	drum compartment cover MEDIUM PRESSURE	0185.583
101	gasket 156 x 141.7 x 1 HIGH PRESSURE and CHEMICAL version	2135.256
102	drum compartment cover HIGH PRESSURE and CHEMICAL version.	0185.814
103	lock bracket for HIGH PRESSURE and CHEMICAL version	0854.949
	set of O-rings and gaskets (contains no.: 10, 36, 38, 41, 44, 45, and 101)	0854.966

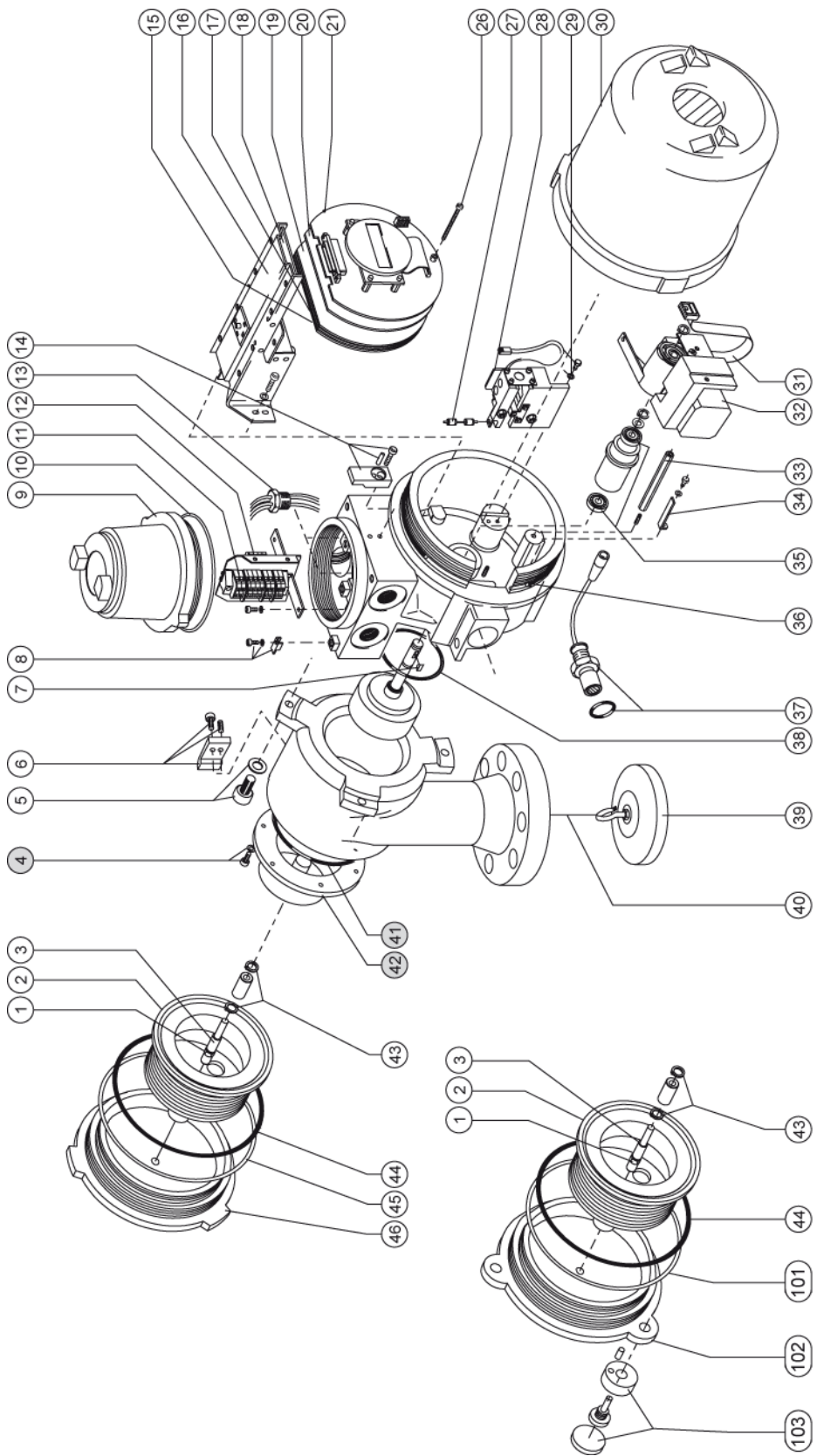

The magnet cap can be part of the drumhouse, in that case No. 4, 41 and 42 are not applicable.

Appendix B Additional information on displacers

Displacer type	Part number	Displacer area (DA) [cm ²]	Displacer volume (DV) [cm ³]	Displacer weight (DW) [g]
Carbon filled PTFE ø 25 mm	0815.360	+10000000E+02	+10500000E+03	+22300000E+03
ø 45 mm	0815.343	+16000000E+02	+10500000E+03	+22300000E+03
ø 90 mm	0815.344	+64000000E+02	+10500000E+03	+22300000E+03
ø 110 mm	0815.345	+95000000E+02	+10500000E+03	+22300000E+03
Stainless steel ø 90 mm	0815.171	+64000000E+02	+60000000E+02	+22300000E+03
ø 110 mm	0815.173	+95000000E+02	+10000000E+03	+22300000E+03
ø 140 mm	0815.175	+15400000E+03	+17500000E+03	+22300000E+03
Density displacer (stainless steel) ø 90 mm	0815.350	+64000000E+02	approximately 200; exact value is engraved on displacer	approximately 265; exact value is engraved on displacer
ø 43 mm	0815.355	+16000000E+02		

Standard displacer

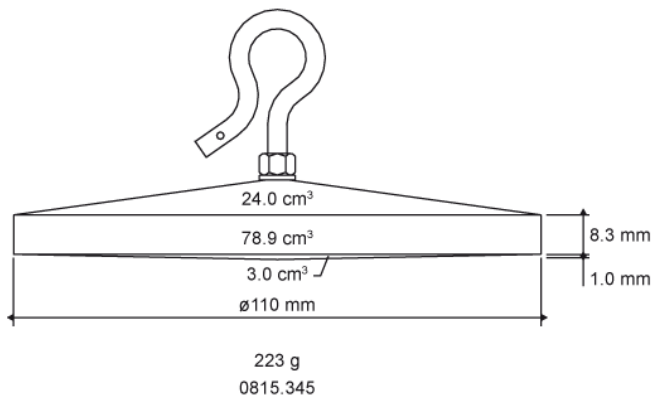
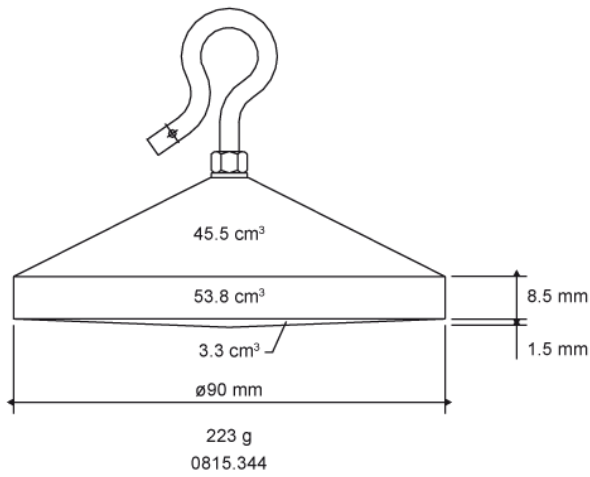
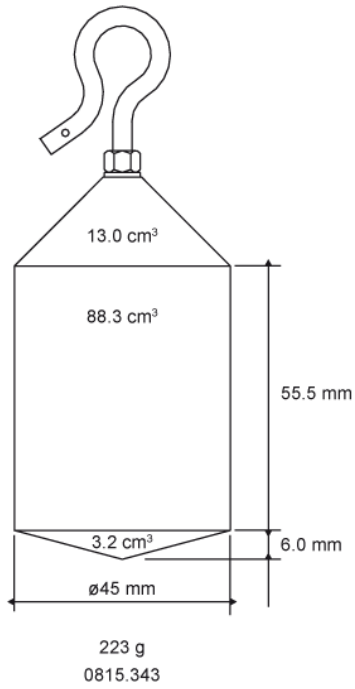

Density displacer

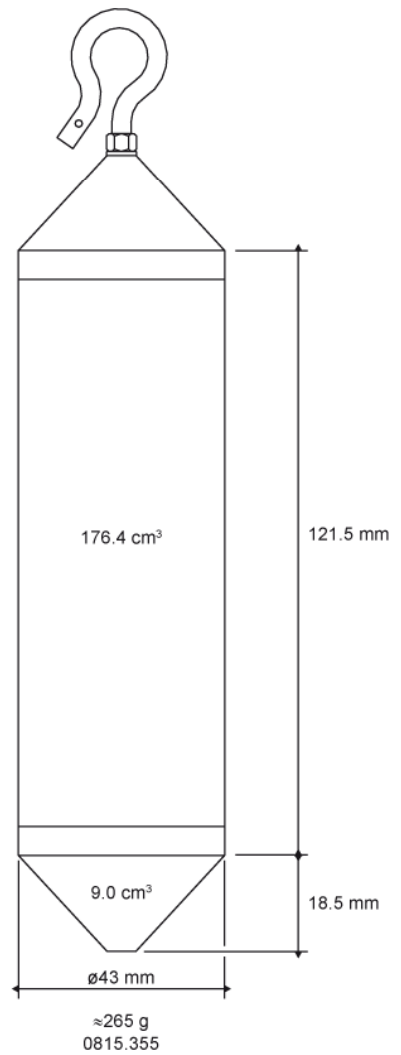
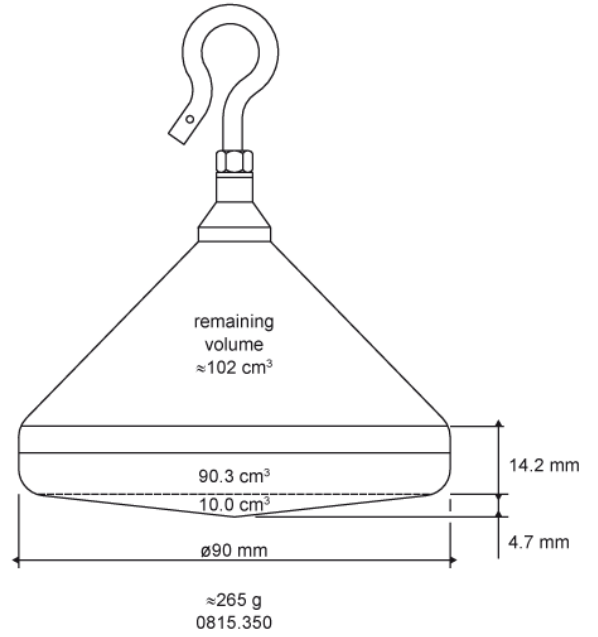

Appendix C ASCII table

HEX	MSB				0	1	2	3	4	5	6	7
	BIT				6 5 4	6 5 4	6 5 4	6 5 4	6 5 4	6 5 4	6 5 4	6 5 4
	3	2	1	0	0 0 0	0 0 1	0 1 0	0 1 1	1 0 0	1 0 1	1 1 0	1 1 1
0	0	0	0	0	NUL	DLE	SP	0	@	P	`	p
1	0	0	0	1	SOH	DC1	!	1	A	Q	a	q
2	0	0	1	0	STX	DC2	"	2	B	R	b	r
3	0	0	1	1	ETX	DC3	#	3	C	S	c	s
4	0	1	0	0	EOT	DC4	\$	4	D	T	d	t
5	0	1	0	1	ENQ	NAK	%	5	E	U	e	u
6	0	1	1	0	ACK	SYN	&	6	F	V	f	v
7	0	1	1	1	BEL	ETB	'	7	G	W	g	w
8	1	0	0	0	BS	CAN	(8	H	X	h	x
9	1	0	0	1	HT	EM)	9	I	Y	i	y
A	1	0	1	0	LF	SUB	*	:	J	Z	j	z
B	1	0	1	1	VT	ESC	+	;	K	[k	{
C	1	1	0	0	FF	FS	,	<	L	\	l	l
D	1	1	0	1	CR	GS	-	=	M]	m	}
E	1	1	1	0	SO	RS	.	>	N	^	n	~
F	1	1	1	1	SI	US	/	?	O	-	o	DEL

Appendix D Display formats

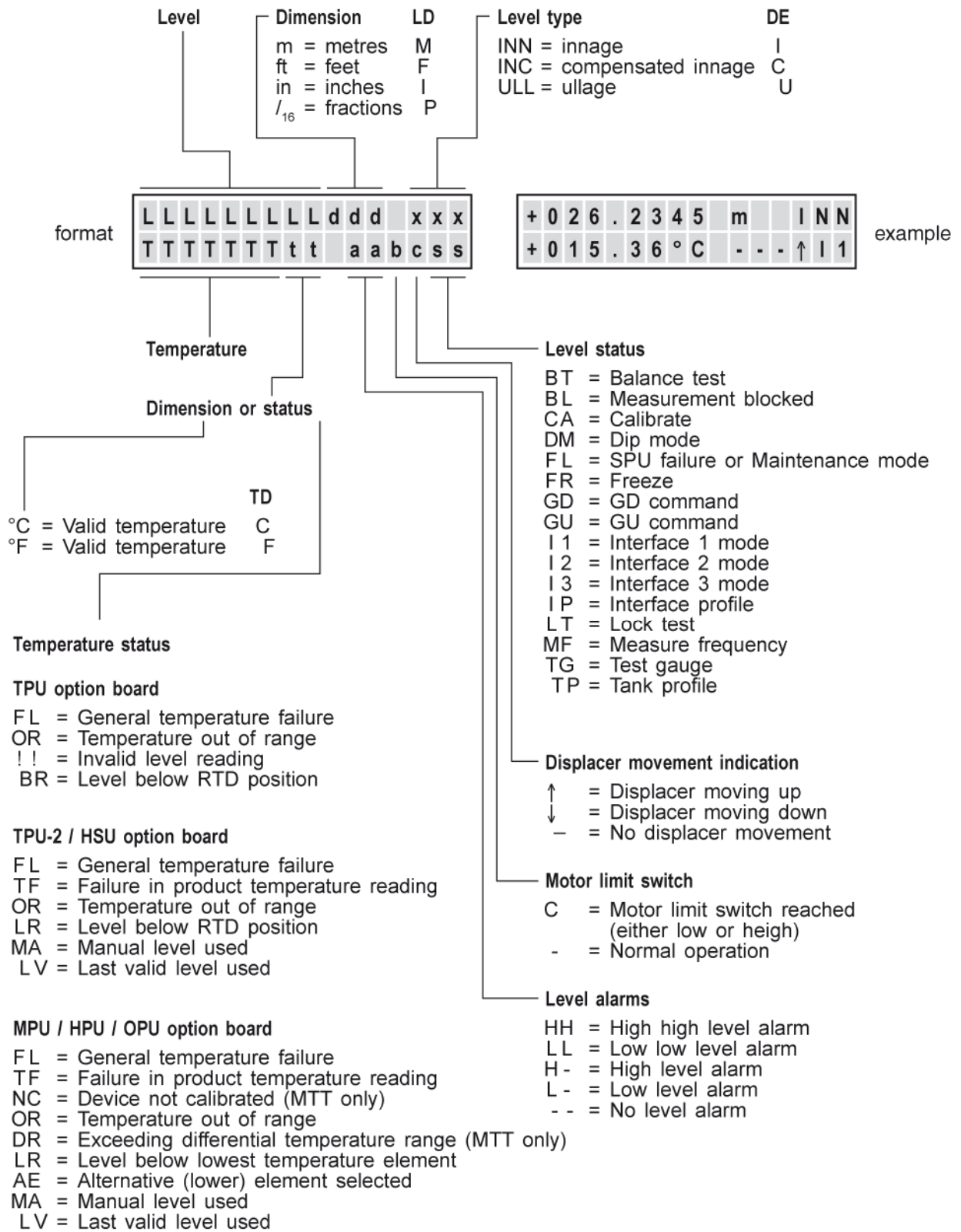

Level and Temperature display (format A)

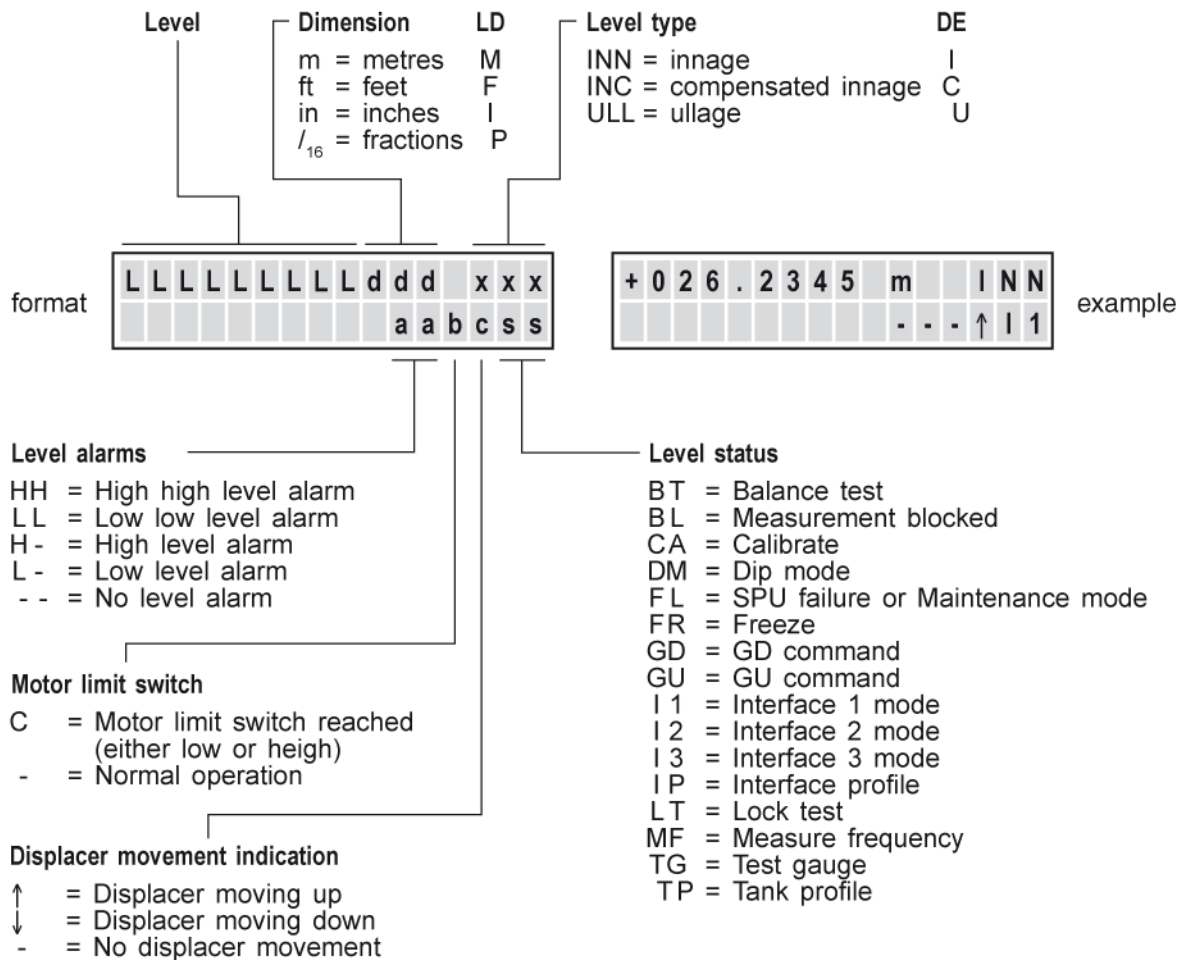

Level display (format B)

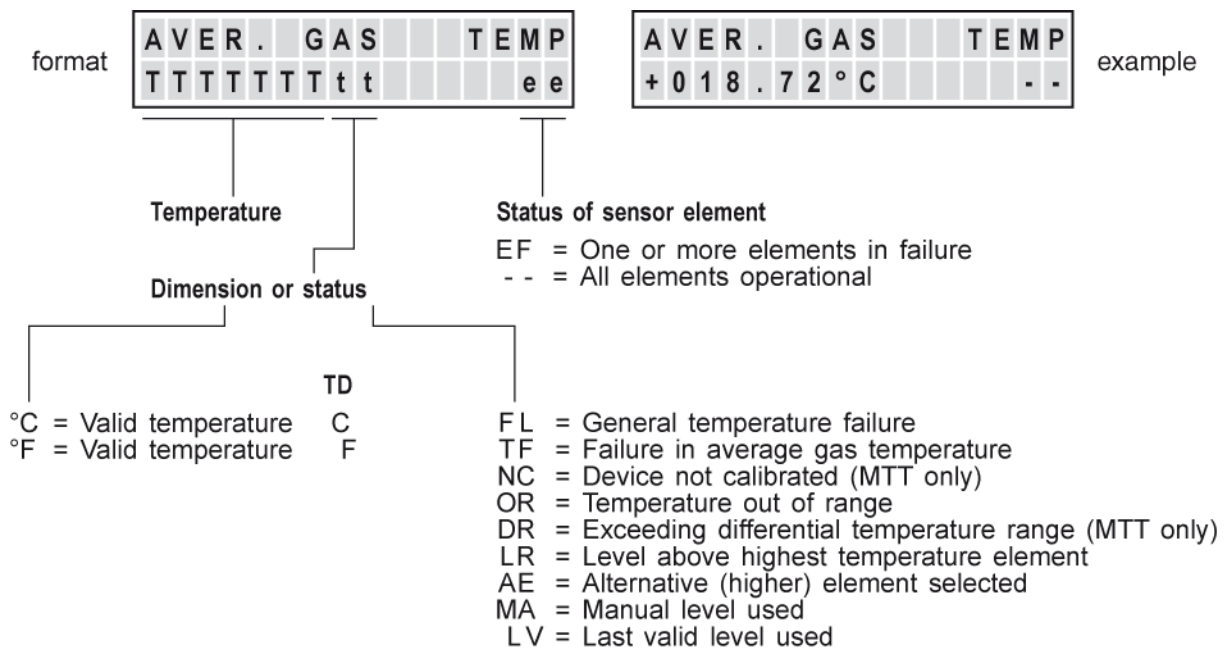

Average gas temperature display (format C)

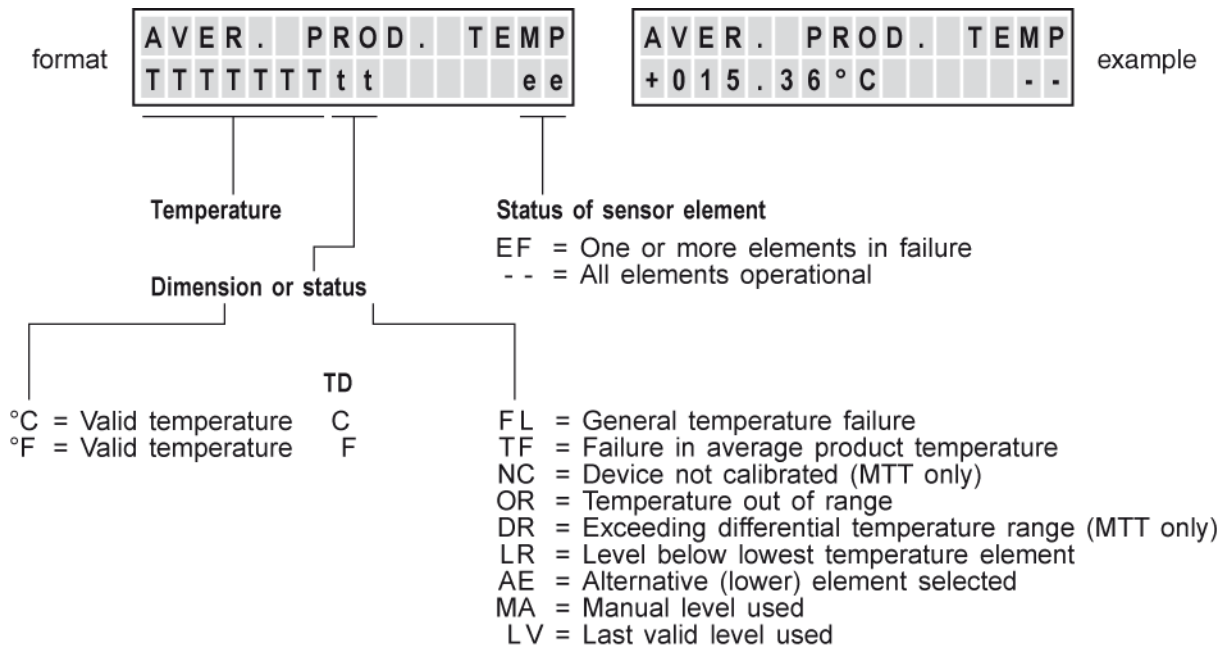

Average product temperature display (format D)

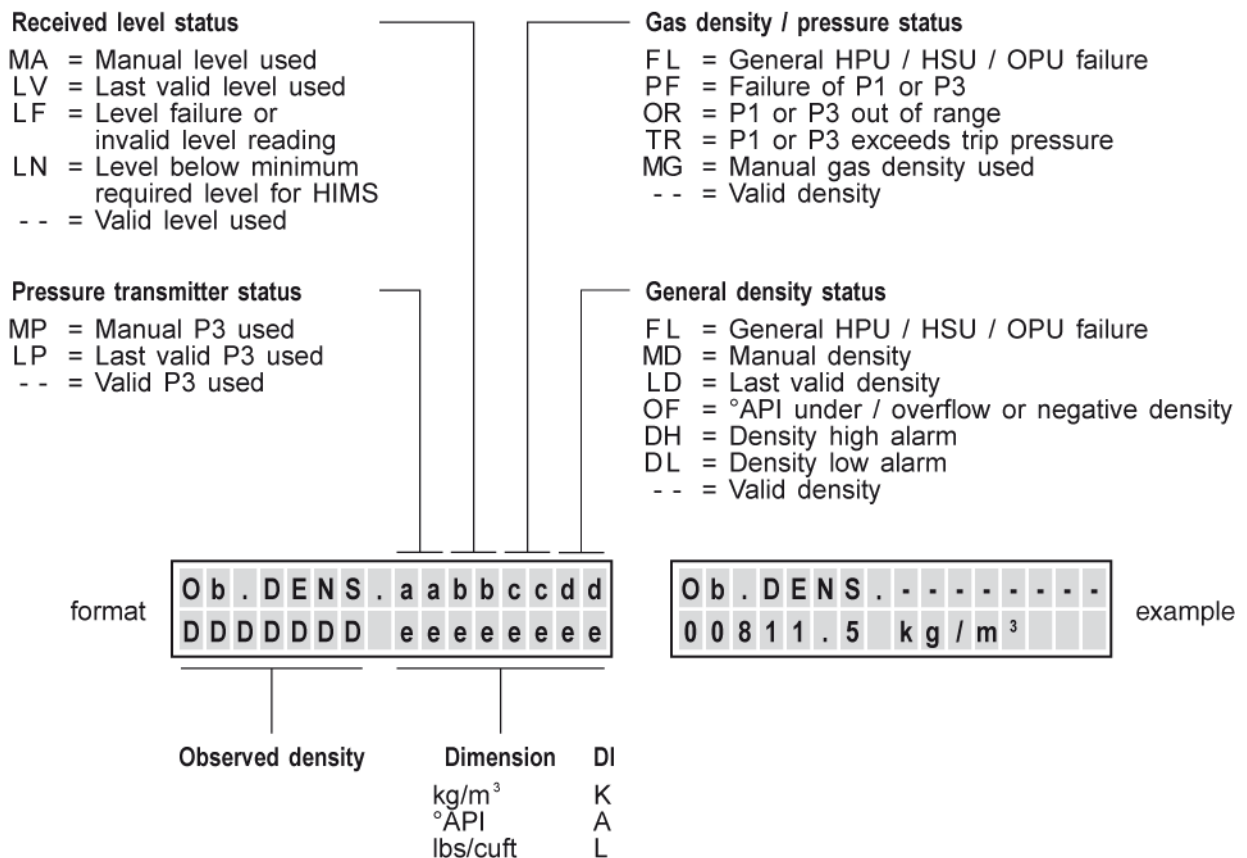

HIMS density display (format E)

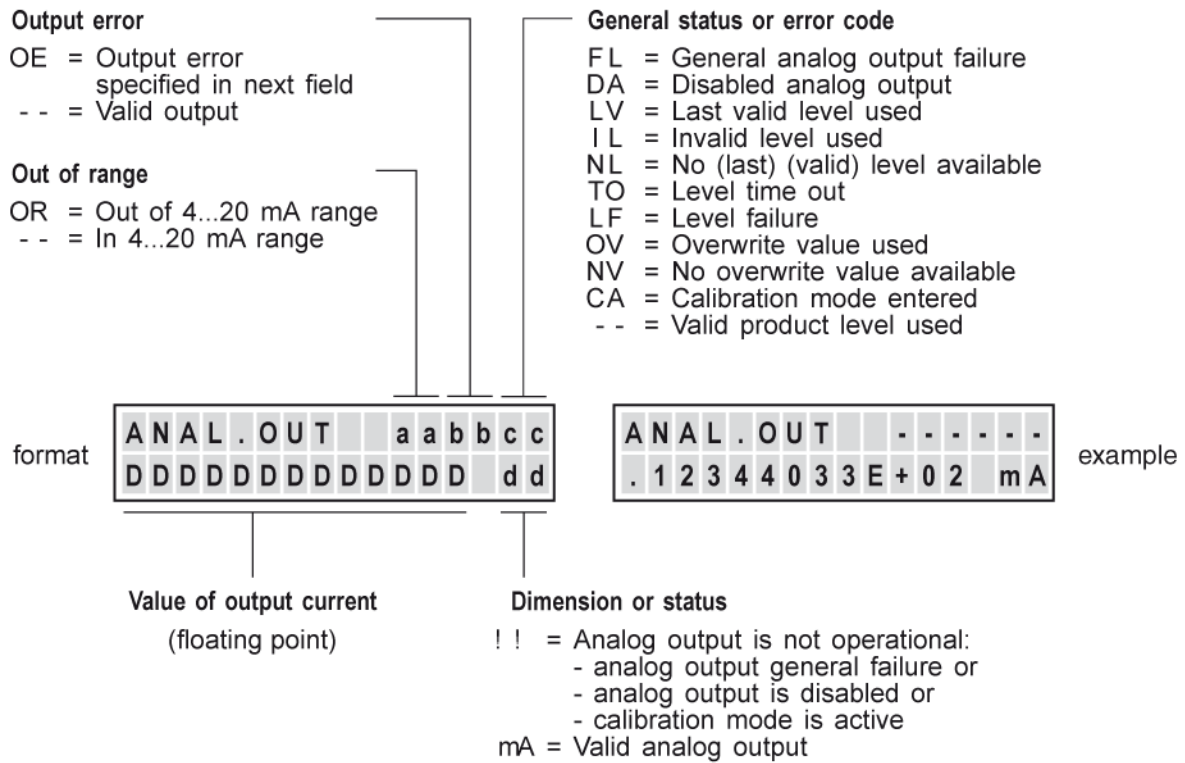

Analog level output display (format J)

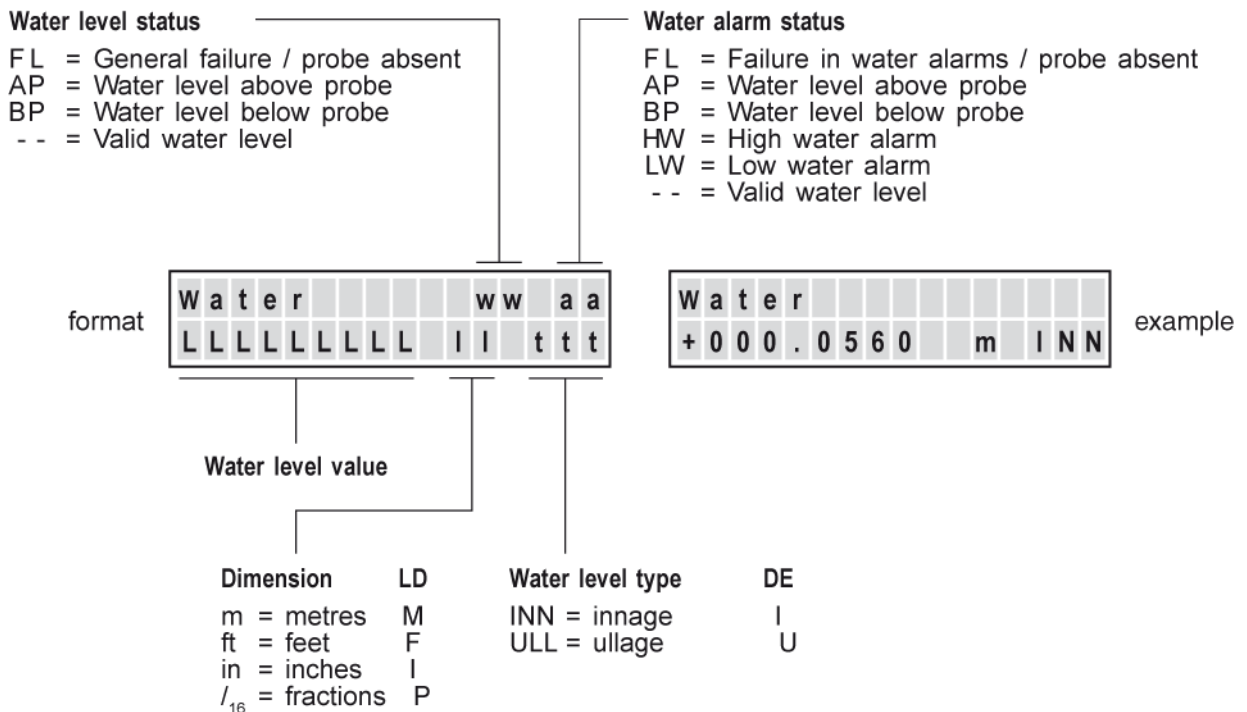

Water level display (format K)

Appendix E PCB layout



XPU-2

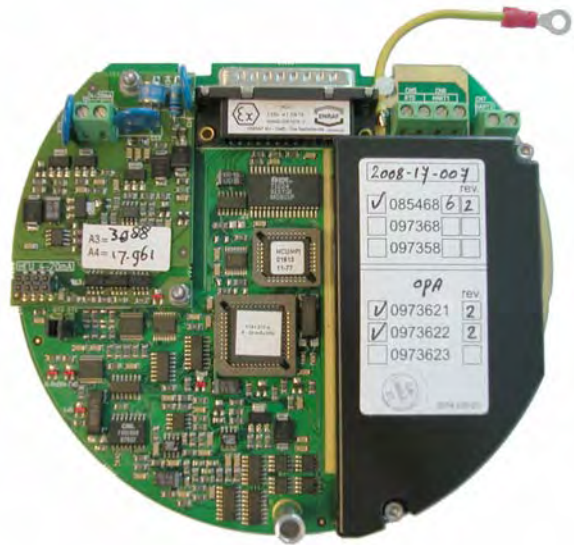

HCU

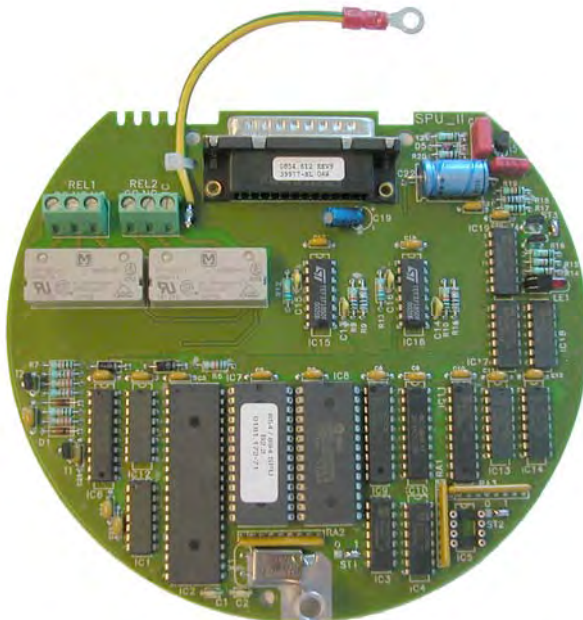

SPU-II

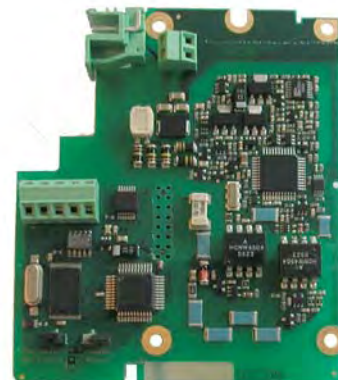

GFC

Appendix F Related documents

Installation guide 854 Advanced Technology Gauge

Instruction manual SPU II Hard alarm output contacts

Instruction manual MPU analog output 4-20 mA

Instruction manual 854 density option

Instruction manual XPU-2 option RS-232C / RS-485

Instruction manual Temperature, water bottom and Analog output options

Instruction manual VITO

Instruction manual HIMS

Instruction manual 977 Tank Side Indicator

Instruction manual 847 Portable Enraf Terminal

Instruction manual Ensite service tool

Item documentation for Honeywell Enraf series 854 level gauges, 873 SmartRadar and 877 FDI

Protocol manual for 854 series level gauges

Instruction manual Foundation™ Fieldbus

Index

3Z.....	28	Displacer.....	7, 13, 23, 37, 38, 42, 44
Accept reference.....	23, 24	area.....	19
AH.....	20	hook.....	13
Alarm relays.....	7, 8	volume.....	7, 13, 25
Alarm settings.....	20	weight.....	7, 13, 19, 25, 34, 44
Analog level output.....	8	Display.....	26
AR.....	23, 24	configuration.....	28
ATG.....	6, 16	contrast.....	27
Average measured frequency.....	33, 42	format toggle.....	28
Average measured weight.....	33	scroll.....	28
Average temperature.....	8	XPU.....	26
Back-plane.....	39	XPU-2.....	26, 27
Balance test.....	33, 34, 42	Display format.....	22, 26, 27
Ball valve.....	24, 32, 37	toggle.....	28
BF.....	33, 42	Display selection.....	22
BL.....	30, 33	DJ.....	22
Block.....	30, 33	DM.....	31, 33
mode.....	30	DP.....	17
Blocking facilities.....	9	Drum circumference.....	12, 19
BM.....	30	Drum compartment.....	36
BT.....	33, 34, 42	Drum shaft.....	12, 36
BU.....	33, 34	bushing.....	36, 38
BV.....	33, 34	DV.....	25
BW.....	33	DW.....	19, 25
CA.....	23, 24, 32, 33	DY.....	22
Calibrate.....	23, 24, 32, 33	Electronic compartment.....	40
Carbon PTFE bearings.....	36	Encoder disk.....	7
Caution.....	10	Honeywell Enraf field bus.....	21
CD.....	27	ENRAF1.....	22
CIU.....	19	ENRAF2.....	16, 17, 19, 22
Commands.....	14, 33	Ensite.....	14
Compensated servo innage.....	33	EP.....	33, 45
Covers.....	35	EPROM.....	40, 41
CPI.....	8	Error SPU request.....	33, 45
CQ.....	33	Error XPU request.....	33, 45
DA.....	19	ES.....	33, 45
Data items.....	33	EX.....	14, 16, 17, 19
Data requests.....	14	Exit.....	14, 16, 17, 19
Datum plate.....	21	Explosion proof.....	9, 35
DC.....	19	F0.....	42, 43
DE.....	21	F1, F2, F3.....	43
Decimal separator.....	17	FDI.....	8
Density.....	7, 8	Feet.....	17
displacer.....	13, 19, 43	Find position.....	43
product.....	25	Force transducer.....	7, 13, 39, 40
water.....	25	calibration.....	42
DF.....	22	FP.....	43
DG.....	22	FQ.....	33, 43
DH.....	31	FR.....	16, 24, 30, 32-34, 44
Diagnostic view.....	28	Fractions.....	17
Dip height.....	31	Freeze.....	16, 24, 30, 32-34, 44
Dip mode.....	22, 31, 33	Frequency constant 0, 1, 2, 3.....	43
Dip time interval.....	31	Frequency request.....	33
Gauge data.....	18	Gauge type.....	19
Gauge Power Supply.....	39	GD.....	44
Go down.....	44	Grease.....	35
GPS.....	39, 40	GT.....	19

HA	20	Motor block	13, 39, 40, 43
Hall switches	27	Motor limit switch high	19
HC	45	position	23
Health	10	Motor limit switch low	19
HH	20	Motor shaft	7
Highway	19	MZ	19, 29
Host command	45	Note	10
I1	22, 31, 33	NOVRAM	40, 41
I2, 3	22, 25, 31, 33	initialization	41
Immersion depth	24, 25	item view	28
IN	41	settings	14
Inches	17	Optional board	39
Infra-red connector	40	Password 1	15, 22
Initialize	19	Password 2	15-17, 19, 22
Innage	21	PCB retaining screw	40
Instrument covers	35	PET	9, 14, 16
Interface	7	Portable Enraf Terminal	9, 14
Interface 1	31, 33	Power	16
Interface 2, 3	25, 31, 33	Pressure	8
Intrinsically safe	9, 35	Printed circuit board	40
Items	14	Product measurement	22, 31
format depended	17	Protection level 1	15
JS	14	Protection level 2	15-17, 19
Jumper setting	14	QS	33, 46
L3	25	Reference encoder	7
LA	20	synchronizing	43
LD	17	Reference level	16, 23, 24, 32
Level alarm	20	Repeatability test	23, 27, 29, 34
high	20	Reset	16
high high	20	RL	23, 24, 32
hysteresis	20	RS	16
low	20	RS-232C	8
low low	20	RS-485	8
Level dimension	17, 22	S1	19
Level offset I3	25	S3	25
Level type	21	Safety	9, 10
LL	20	Servo innage	33
Lock test	29, 33	Servo Processing Unit	39
limit switch	29	Servo status request	33
limit switch level	19	Servo ullage	33
Locking latch	40	Set maintenance	43, 44
Log file	14	Set operational	43, 44
LQ	33	Set point 1	19
LT	29, 33	Set point 3	25
Magnet	27		
cap	36		
coupling	7, 9		
Manual dipping	23		
Maximum unbalanced weight	33, 34		
Measure frequency	33, 34		
Measuring drum	7, 12, 44		
bearings	38		
removing	37		
unbalance	34		
Measuring wire	7, 13, 37, 44		
weight compensation	19		
Metres	17		
MF	33, 34, 43		
MH	19		
Minimum unbalanced weight	33, 34		
ML	19		

SM	43, 44	Ullage	21
SO	43, 44	UN	16, 24, 30, 32, 33
Software version	17, 41	Unlock	16, 24, 30, 32, 33
Span wire	13, 40	Upper reference	21
Spot temperature	8	point	21
SPU	39, 40	UQ	33
status request	46	UR	21
Standard floating point format	17	Verify level calibration	32
Stepper motor	7	W&M	14
SV	17, 41	protection	15
System configuration	28	W1	15, 22
TA	19	W2	15-17, 19, 22
Tank adapter	23	Warning	10
Tank data	18	Warranty	2
Tank identifier	19	Water bottom probe	8
Tank Side Indicator	8	Water measurement	22, 31
Tank top	19, 23, 32	Weight request	33, 34
Tank top reference stop	23, 32	Weights & Measures	14
Tenth millimetre selection	22	protection	22
Test gauge	28, 29, 33	Wire rupture	42, 43
Test magnet	27, 41	WM	22
Test weight	12, 42	WQ	33, 34
TG	29, 33	WT	42, 43
TI	19	Xmission Processing Unit	39
Tool set	12	XPU	39, 40
Top of ball valve	24	jumpers	15
Transmission address	19	XPU-2	17, 22, 28
Transmission speed	19	Zero format	22
Transport bracket	13		
TS	19		
TSI	8		
TT	19, 23, 32		